

P-20636

E1290

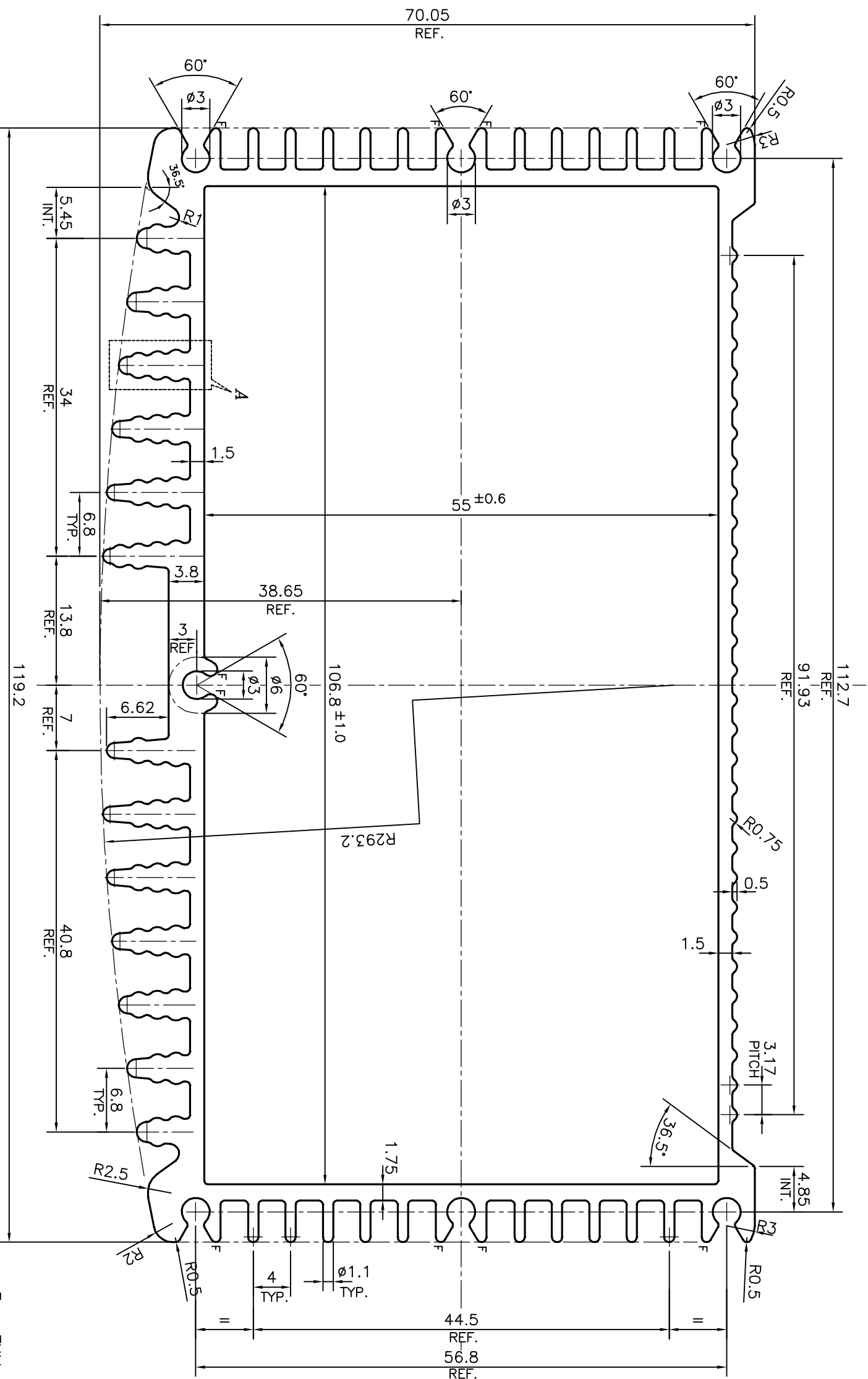

F = FULL RADIUS (10 PLACES)

TOLERANCES ON OVERALL WIDTHS & WIDTHS ACROSS FLATS OF BARS, & REGULAR SECTIONS

UPTO 6.40mm - ±0.20	UPTO 32.0mm - ±0.38	UPTO 120.0mm - ±0.85
UPTO 10.0mm - ±0.23	UPTO 50.0mm - ±0.46	UPTO 160.0mm - ±1.02
UPTO 12.0mm - ±0.25	UPTO 60.0mm - ±0.53	UPTO 200.0mm - ±1.14
UPTO 16.0mm - ±0.28	UPTO 80.0mm - ±0.69	UPTO 250.0mm - ±1.40
UPTO 25.0mm - ±0.30	UPTO 100.0mm - ±0.75	UPTO 300.0mm - ±1.65

1. STRAIGHTNESS=1.7mm/M
2. TWIST=1.7mm/M
3. ANGULARITY= ±2'
4. FLATNESS =0.007xWIDTH

SCALE: - 1:1

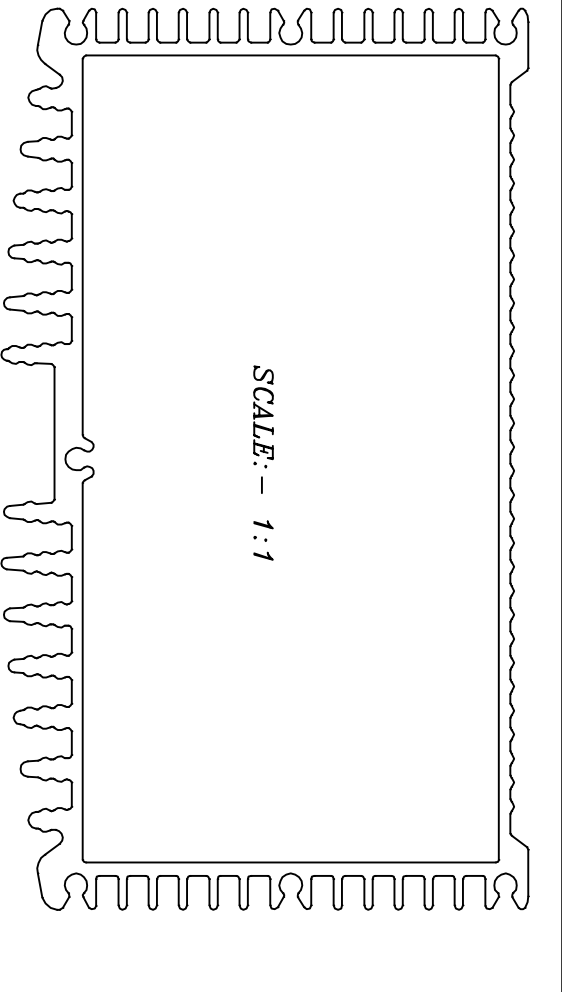

ALL FIN'S DETAIL
SCALE 3:1

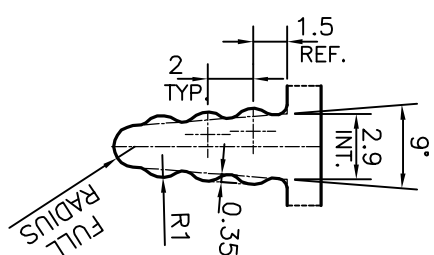

<p>JINDAL ALUMINIUM LTD. BANGALORE-560073 (INDIA)</p>		<p>SYMBOL OF QUALITY AN ISO 9001 COMPANY</p>
<p>1. ALL DIMENSIONS ARE IN mm. 2. ROUND OFF ALL SHARP CORNERS WITH 0.40 mm. 3. TOLERANCES WILL BE AS PER IS:6477-1983, UNLESS OTHERWISE SPECIFIED</p>		
PARTY'S NAME	CINGULARITY TEC INDIA PVT. LTD., BANGALORE	
PARTY'S DRAWING No.	AS PER PROPOSAL DRAWING	
ALLOY & TEMPER	6063 T6	
DESCRIPTION	ELECTRICAL SECTION	
DRAWN	NAME	DATE
CHECKED	PARVESH	23-01-2020
APPROVED	B.NATARAJA	27-01-2020
SCALE	2:1	
AREA	mm ²	1075.815
PERIMETER	mm.	805.353
WEIGHT	kg/m	2.905
DRAWING No.	SECTION No.	
P-20636	-	
E1290	E1290	