

P-20766

E1301

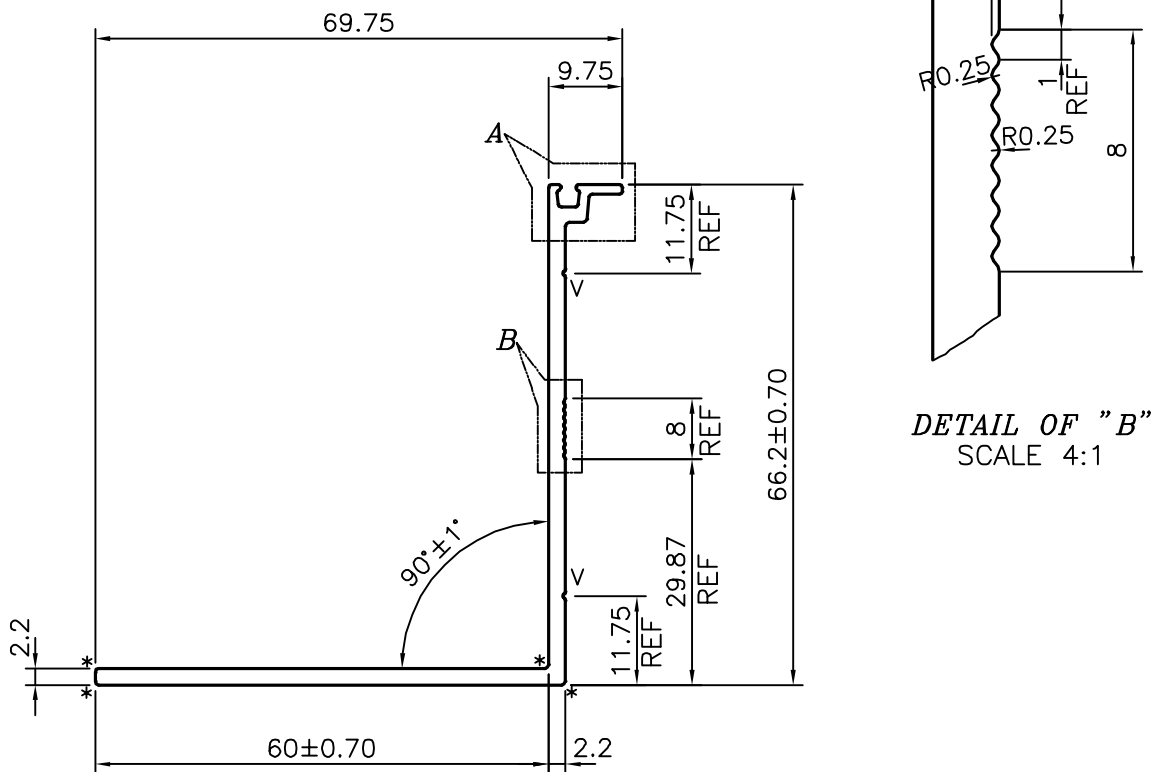

V = V GROOVE 0.3x90° (2 PLACES)
 * = 0.50 RADIUS (6 PLACES)

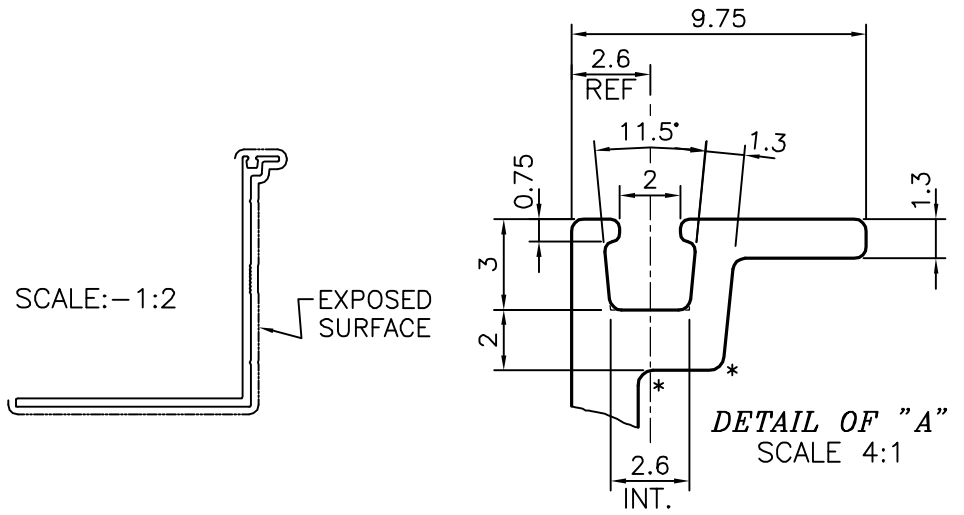

SYMBOL OF QUALITY
 AN ISO 9001 COMPANY

JINDAL ALUMINIUM LTD.
 BANGALORE-560073 (INDIA)

	NAME	DATE
DRAWN	J.P.KAUSHIK	17-02-2020
CHECKED		
APPROVED	B.NATARAJA	27-02-2020
SCALE		1:1
AREA	mm ²	289.179
PERIMETER	mm.	277.766
WEIGHT	kg/m	0.781
DRAWING No.	SECTION No.	
P-20766	-	
E1301	E1301	

1. ALL DIMENSIONS ARE IN mm.
2. ROUND OFF ALL SHARP CORNERS WITH 0.40 mm.
3. TOLERANCES WILL BE AS PER BS:EN-755-9 UNLESS OTHERWISE SPECIFIED

PARTY'S NAME	CLEAR AMBER GROUP, UK
PARTY'S DRAWING No.	209907
ALLOY & TEMPER	6063 T6
DESCRIPTION	SMALL CLOSING PLATE SECTION