

P-21208
E1357

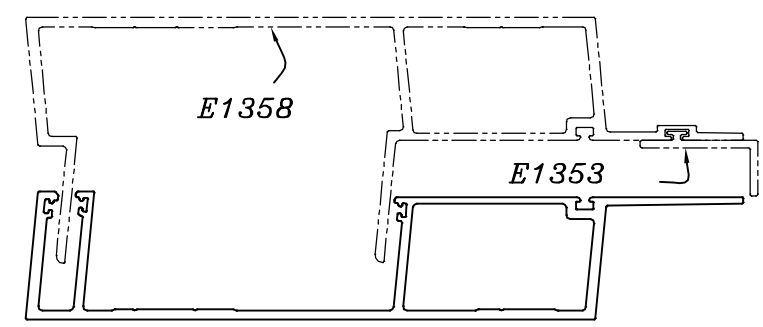

SCALE:- 0.5:1

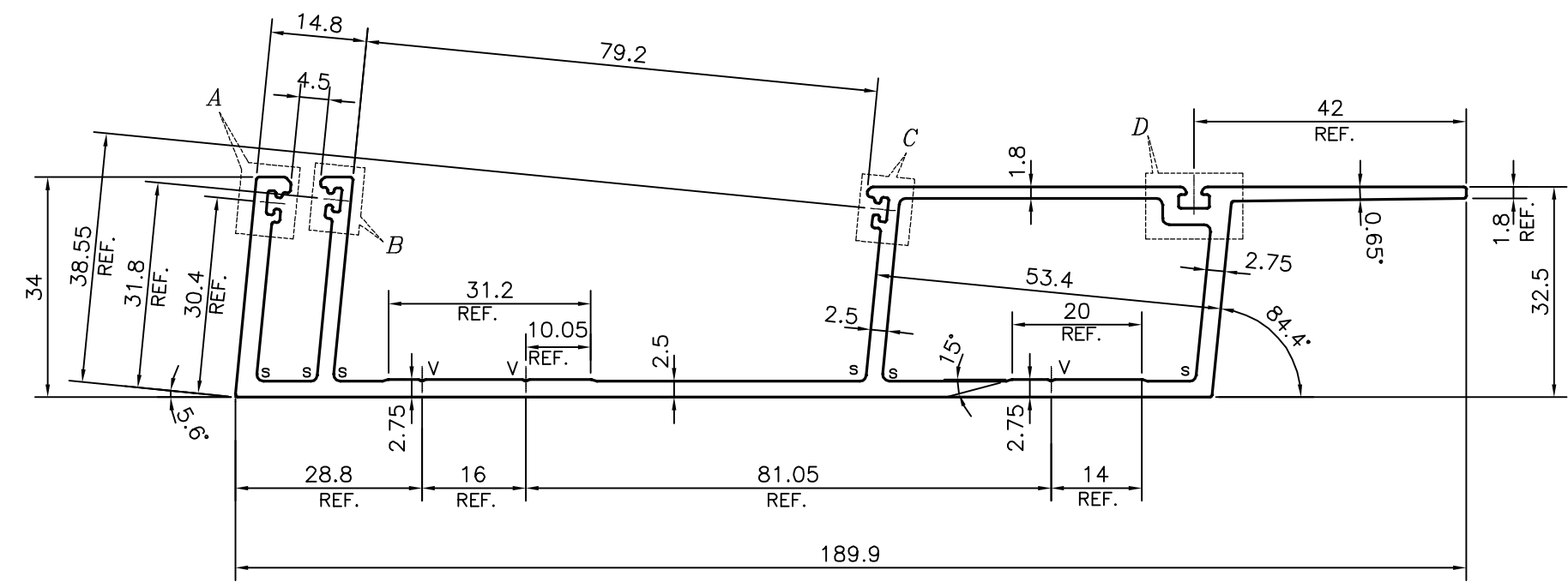

V = VEE GROOVE 0.3x90° (3 PLACES)
X = RADIUS 0.3 mm. (30 PLACES)
S = RADIUS 1.0 mm. (11 PLACES)

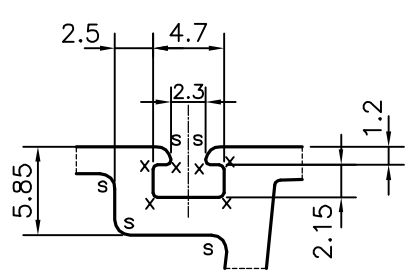

DETAIL OF "D"
SCALE 2:1

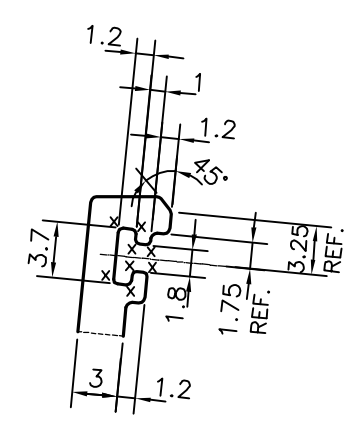

DETAIL OF "A"
SCALE 2:1

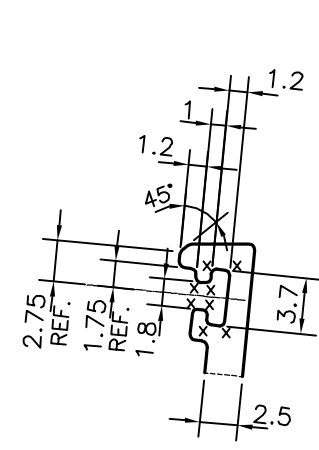

DETAIL OF "B"
SCALE 2:1

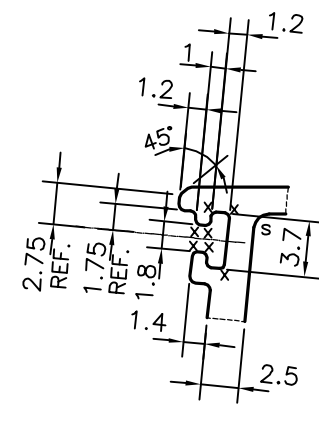

DETAIL OF "C"
SCALE 2:1

TOLERANCES ON OVERALL WIDTHS & WIDTHS ACROSS FLATS OF BARS, & REGULAR SECTIONS											
UPTO 6.40mm - ±0.20	UPTO 32.0mm - ±0.38	UPTO 120.0mm - ±0.85	1. STRAIGHTNESS=1.0mm/M 2. TWIST=1.0mm/M 3. ANGULARITY= ±1° 4. FLATNESS =0.007xWIDTH								
UPTO 10.0mm - ±0.23	UPTO 50.0mm - ±0.46	UPTO 160.0mm - ±1.02									
UPTO 12.0mm - ±0.25	UPTO 60.0mm - ±0.53	UPTO 200.0mm - ±1.14									
UPTO 16.0mm - ±0.28	UPTO 80.0mm - ±0.69	UPTO 250.0mm - ±1.40									
UPTO 25.0mm - ±0.30	UPTO 100.0mm - ±0.75	UPTO 300.0mm - ±1.65									
 SYMBOL OF QUALITY AN ISO 9001 COMPANY		JINDAL ALUMINIUM LTD. BANGALORE-560073 (INDIA)									
1. ALL DIMENSIONS ARE IN mm. 2. ROUND OFF ALL SHARP CORNERS WITH 0.4 mm. 3. TOLERANCES WILL BE AS PER IS:6477-1983 , UNLESS OTHERWISE SPECIFIED		<table border="1"> <thead> <tr> <th>NAME</th> <th>DATE</th> </tr> </thead> <tbody> <tr> <td>DRAWN <i>PARVESH</i></td> <td>24-07-2020</td> </tr> <tr> <td>CHECKED</td> <td></td> </tr> <tr> <td>APPROVED <i>B.NATARAJA</i></td> <td>11-08-2020</td> </tr> </tbody> </table>		NAME	DATE	DRAWN <i>PARVESH</i>	24-07-2020	CHECKED		APPROVED <i>B.NATARAJA</i>	11-08-2020
NAME	DATE										
DRAWN <i>PARVESH</i>	24-07-2020										
CHECKED											
APPROVED <i>B.NATARAJA</i>	11-08-2020										
PARTY'S NAME ALUFIT (INDIA) PRIVATE LIMITED, BANGALORE		SCALE 1:1									
PARTY'S DRAWING No. AS PER AUTOCAD DRAWING-AL-22		AREA mm ² 913.337									
ALLOY & TEMPER 6063 T6		PERIMETER mm. 605.333									
DESCRIPTION CURTAIN WALL SECTION-FEMALE MULLION		WEIGHT kg/m 2.466									
		DRAWING No. SECTION No. P-21208 - E1357 E1357									