

P-JAL-B-342-1

G101495

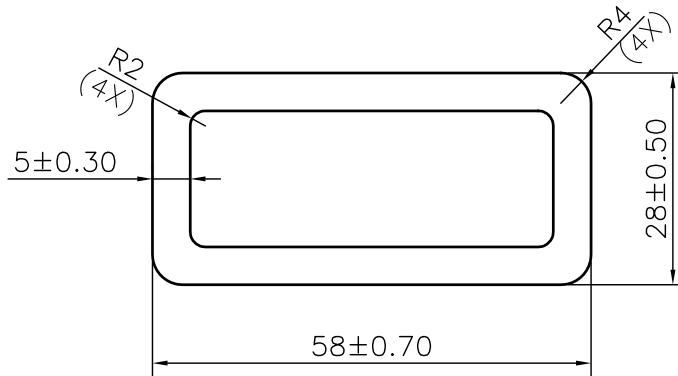

1. STRAIGHTNESS= 1.7mm/M
2. TWIST= 1.7mm/M
3. ANGULARITY= $\pm 2^\circ$
4. FLATNESS= 0.007xWIDTH

Q00952

CONTROLLED COPY



SYMBOL OF QUALITY
AN ISO 9001 COMPANY

JINDAL ALUMINIUM LTD.
BHIWADI-301019 (INDIA)

	NAME	DATE
DRAWN	ASHUTOSH	06-10-2023
CHECKED	PARVESH	13-10-2023
APPROVED	J.N RAI	13-10-2023
SCALE		1:1
AREA mm ²		749.699
PERIMETER mm.		165.133
WEIGHT kg/m		2.024
DRAWING No.	SECTION No.	
P-JAL-B-342-1	7000001651	
G101495	G101495	

1. ALL DIMENSIONS ARE IN mm.
2. ROUND OFF ALL SHARP CORNERS WITH 0.40 mm.
3. TOLERANCES WILL BE AS PER BS:EN-755-8 , UNLESS OTHERWISE SPECIFIED

PARTY'S NAME	ATCO ALUMINIUM SYSTEM, DELHI	
PARTY'S DRAWING No.	AS PER DRAWING	
ALLOY & TEMPER	6063 T6	PRODUCT CODE:-013
		HSN CODE:- 76042100
DESCRIPTION	RECTANGULAR TUBE-MISC.	