

P-JAL-B-396

G101707

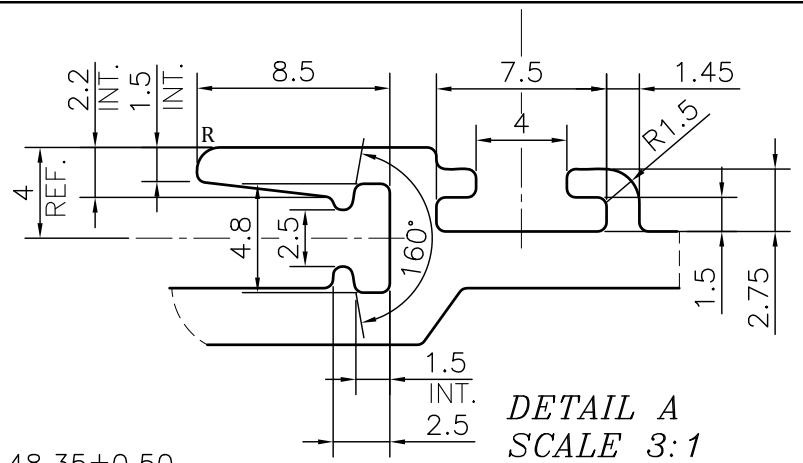

DETAIL A
SCALE 3:1

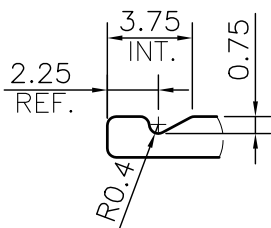
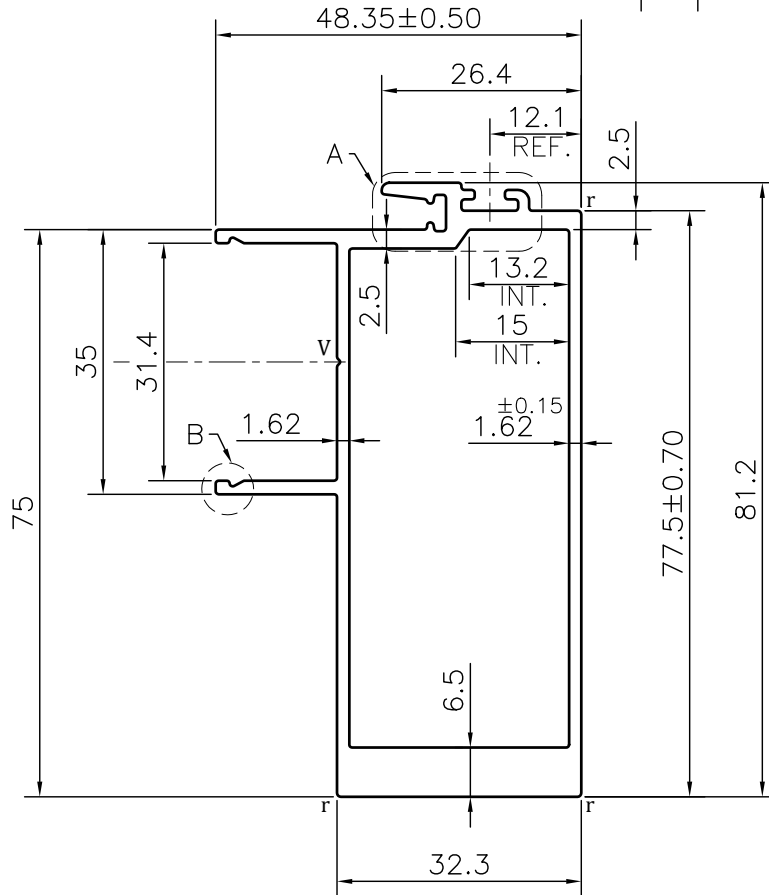

DETAIL B
SCALE 3:1

NOTE:-
r= 0.50 RADIUS (3 PLACES)
R= 1.0 RADIUS (1 PLACE)
V= 0.4x90° V-GROOVE (1 PLACE)

1. STRAIGHTNESS= 1.7mm/M
2. TWIST= 1.7mm/M
3. ANGULARITY= ±2°
4. FLATNESS= 0.007xWIDTH

Q01093

CONTROLLED COPY



SYMBOL OF QUALITY
AN ISO 9001 COMPANY

JINDAL ALUMINIUM LTD.
 BHIWADI-301019 (INDIA)

	NAME	DATE
DRAWN	ASHUTOSH	04-12-2023
CHECKED	PARVESH	16-12-2023
APPROVED	J.N.RAI	16-12-2023

1. ALL DIMENSIONS ARE IN mm.
2. ROUND OFF ALL SHARP CORNERS WITH 0.40 mm.
3. TOLERANCES WILL BE AS PER BS:EN-755-9 , UNLESS OTHERWISE SPECIFIED

SCALE	1:1
AREA mm ²	601.679
PERIMETER mm.	319.364
WEIGHT kg/m	1.625

PARTY'S NAME	GSC ALUSYSTEMS PRIVATE LIMITED, NOIDA		DRAWING No.	P-JAL-B-396	SECTION No.	7000001860
PARTY'S DRAWING No.	AS PER DRAWING-M33557			G101707		G101707
ALLOY & TEMPER	6063 T6	PRODUCT CODE:-048				
		HSN CODE:- 76042100				
DESCRIPTION	WINDOW SECTION					