

P-JAL-B-400

G101783

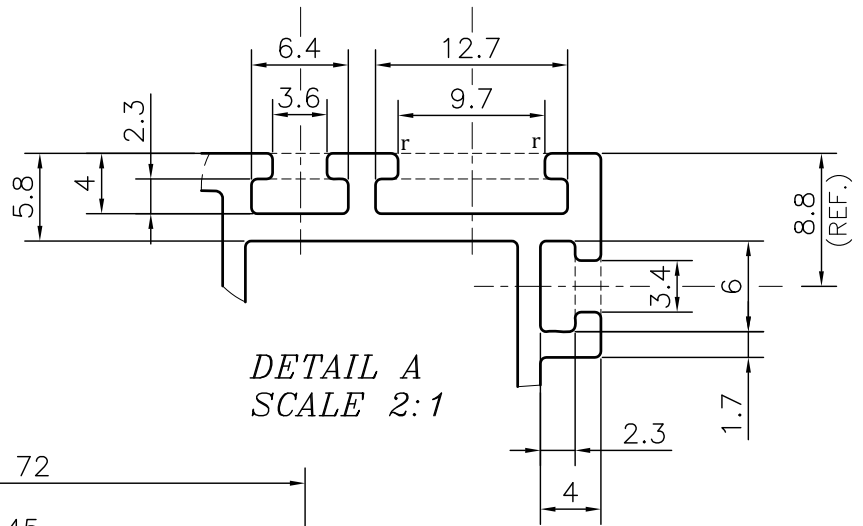

DETAIL A
SCALE 2:1

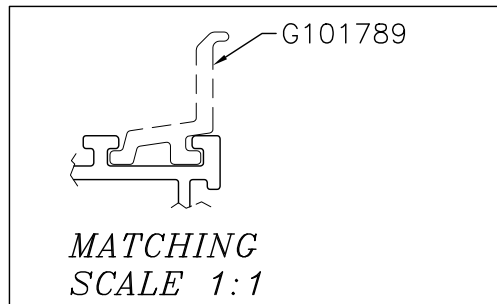
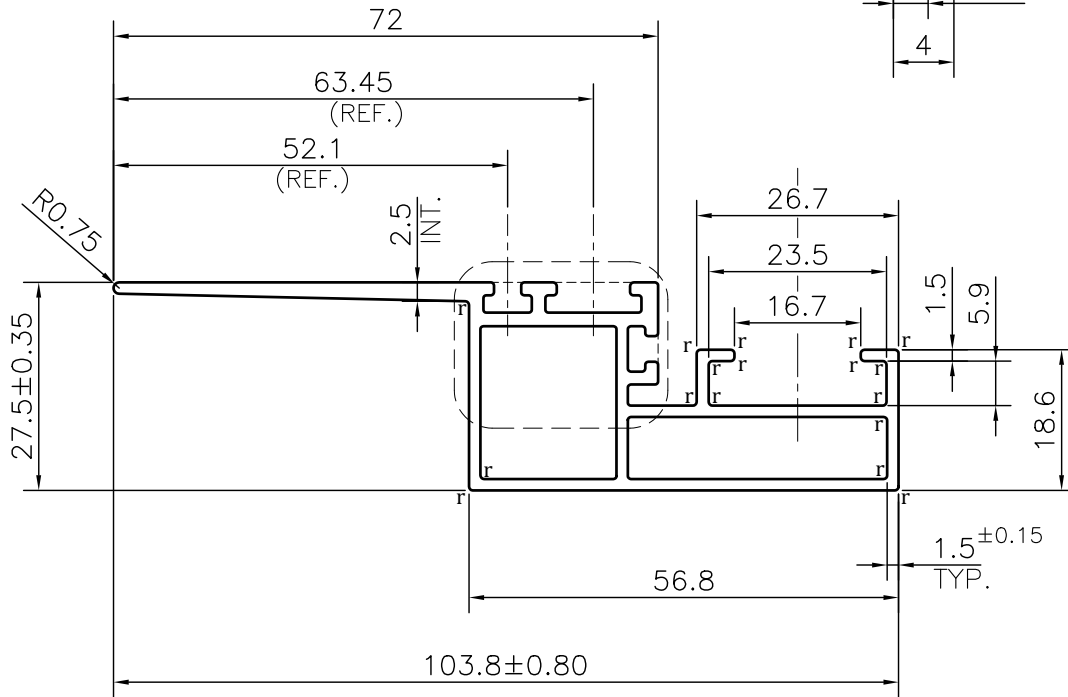

NOTE:-

r= 0.50 RADIUS (19 PLACES)

1. STRAIGHTNESS= 1.7mm/M
2. TWIST= 1.7mm/M
3. ANGULARITY= ±2°
4. FLATNESS= 0.007xWIDTH

Q01147

CONTROLLED COPY



SYMBOL OF QUALITY
AN ISO 9001 COMPANY

JINDAL ALUMINIUM LTD.
BHIWADI-301019 (INDIA)

	NAME	DATE
DRAWN	ASHUTOSH	23-12-2023
CHECKED	PARVESH	09-01-2024
APPROVED	J.N.RAI	10-01-2024
SCALE		1:1
AREA	mm ²	428.932
PERIMETER	mm.	345.08
WEIGHT	kg/m	1.158
DRAWING No.	SECTION No.	
P-JAL-B-400	7000001910	
G101783	G101783	

1. ALL DIMENSIONS ARE IN mm.
2. ROUND OFF ALL SHARP CORNERS WITH 0.40 mm.
3. TOLERANCES WILL BE AS PER BS:EN-755-9 , UNLESS OTHERWISE SPECIFIED

PARTY'S NAME	K.S.V INFRABUILD, GREATER NOIDA	
PARTY'S DRAWING No.	AS PER DRAWING -GLASS FRAME 18.6x103.8x2mm	
ALLOY & TEMPER	6063 T6	PRODUCT CODE:-055
		HSN CODE:- 76042100
DESCRIPTION	CURTAIN WALL SECTION- GLASS FRAME	