

P-JAL-B-401
G101784

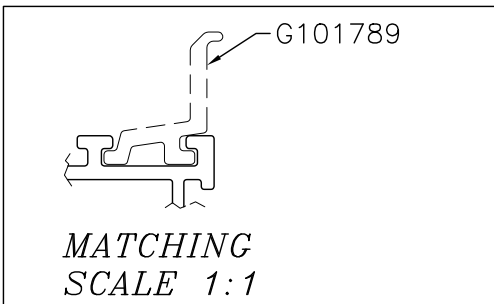
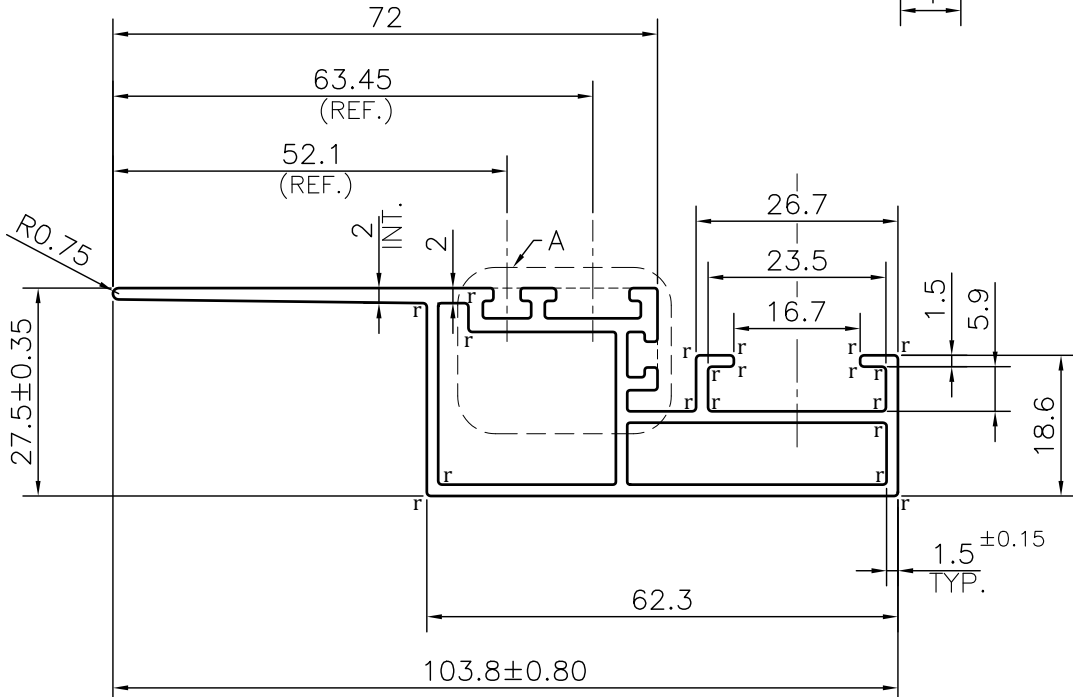
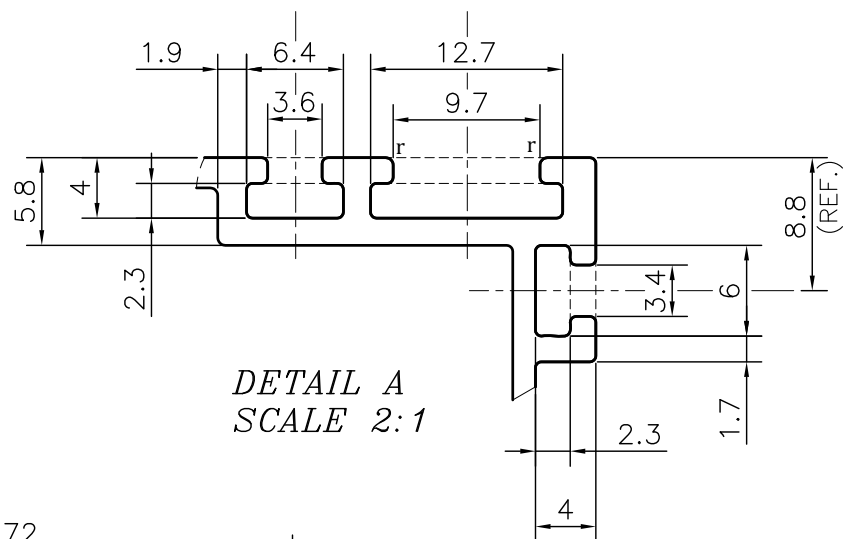

**NOTE:-**  
**r= 0.50 RADIUS (21 PLACES)**

1. STRAIGHTNESS= 1.7mm/M
2. TWIST= 1.7mm/M
3. ANGULARITY= ±2°
4. FLATNESS= 0.007xWIDTH

Q01148  
 CONTROLLED COPY



**JINDAL ALUMINIUM LTD.**  
 BHIWADI-301019 (INDIA)

	NAME	DATE
DRAWN	ASHUTOSH	23-12-2023
CHECKED	PARVESH	09-01-2024
APPROVED	J.N.RAI	10-01-2024

1. ALL DIMENSIONS ARE IN mm.
2. ROUND OFF ALL SHARP CORNERS WITH 0.40 mm.
3. TOLERANCES WILL BE AS PER BS:EN-755-9 , UNLESS OTHERWISE SPECIFIED

SCALE	1:1
AREA mm <sup>2</sup>	432.692
PERIMETER mm.	345.568
WEIGHT kg/m	1.168
DRAWING No.	SECTION No.
P-JAL-B-401	7000001951
G101784	G101784

PARTY'S NAME	K.S.V INFRABUILD, GREATER NOIDA	
PARTY'S DRAWING No.	AS PER DRAWING -GLASS FRAME 18.6x103.8x2mm	
ALLOY & TEMPER	6063 T6	PRODUCT CODE:-055
		HSN CODE:- 76042100
DESCRIPTION	CURTAIN WALL SECTION- GLASS FRAME	