

P-JAL-B-420-1

G101811

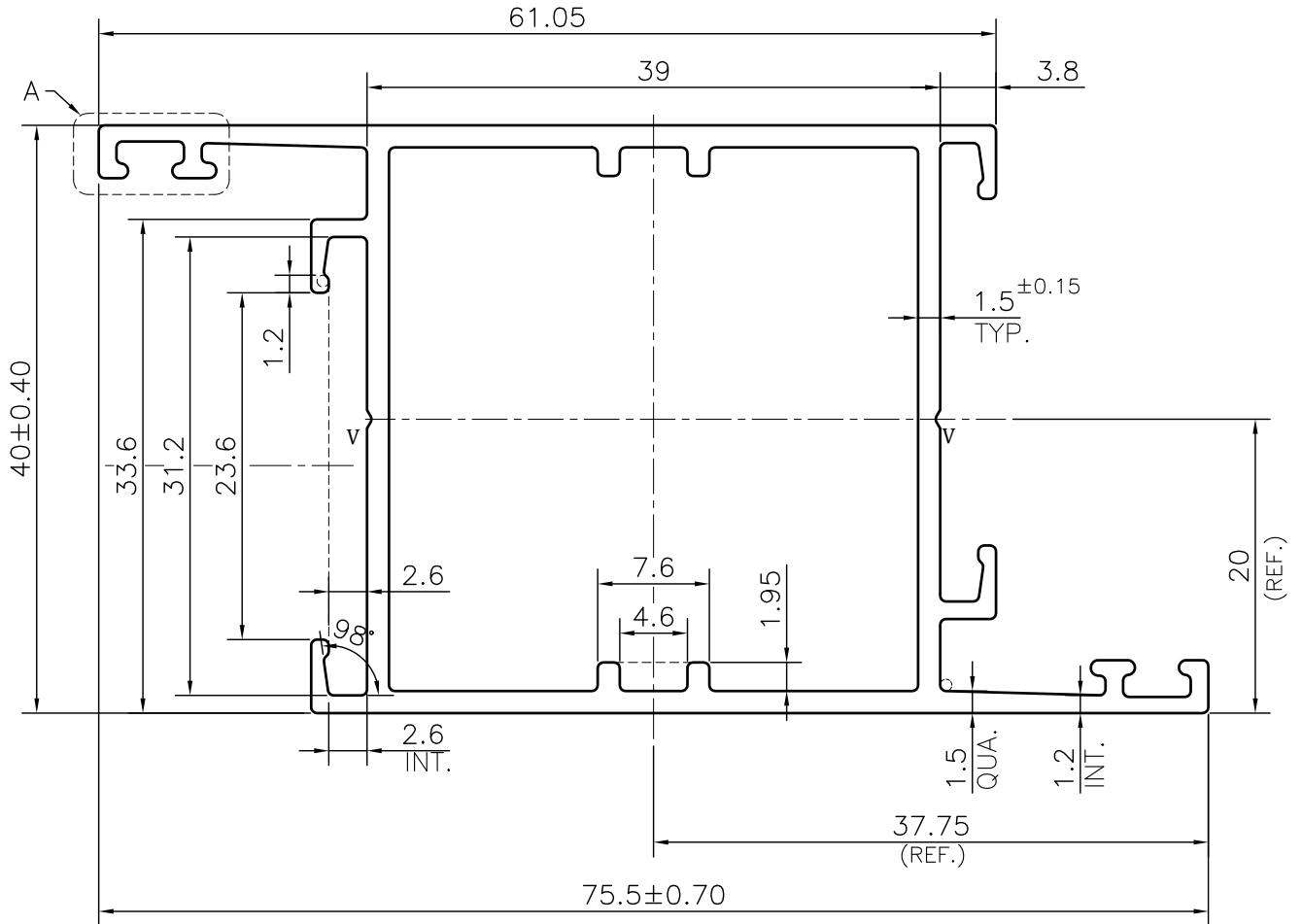
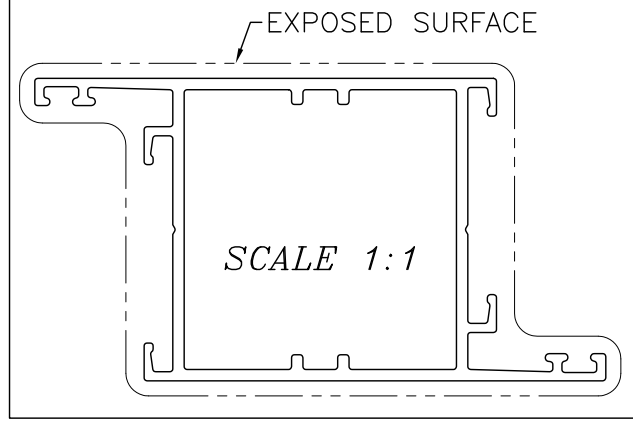
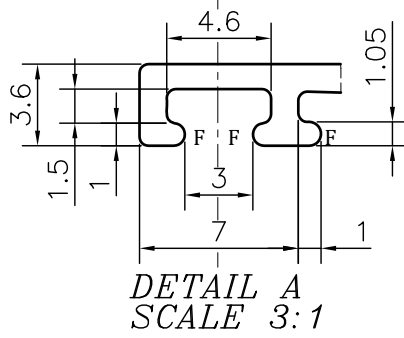

NOTE:-
F= FULL RADIUS (6 PLACES)
V= 0.30x120° V-GROOVE (2 PLACES)

1. STRAIGHTNESS= 1.7mm/M
2. TWIST= 1.7mm/M
3. ANGULARITY= ±2°
4. FLATNESS= 0.007xWIDTH

Q01170

CONTROLLED COPY



SYMBOL OF QUALITY
AN ISO 9001 COMPANY

JINDAL ALUMINIUM LTD.
BHIWADI-301019 (INDIA)

	NAME	DATE
DRAWN	ASHUTOSH	26-12-2023
CHECKED	PARVESH	20-01-2024
APPROVED	J.N.RAI	20-01-2024
SCALE		2:1
AREA mm ²		336.661
PERIMETER mm.		312.732
WEIGHT kg/m		0.909
DRAWING No.	SECTION No.	
P-JAL-B-420-1	7000001974	
G101811	G101811	

1. ALL DIMENSIONS ARE IN mm.
2. ROUND OFF ALL SHARP CORNERS WITH 0.40 mm.
3. TOLERANCES WILL BE AS PER BS:EN-755-9 , UNLESS OTHERWISE SPECIFIED

PARTY'S NAME	GSC ALUSYSTEMS PRIVATE LIMITED, NOIDA	
PARTY'S DRAWING No.	AS PER PROPOSAL DRAWING-M32966	
ALLOY & TEMPER	6063 T6	PRODUCT CODE:-048
		HSN CODE:- 76042100
DESCRIPTION	WINDOW SECTION	