

P-JAL-B-490

G102238

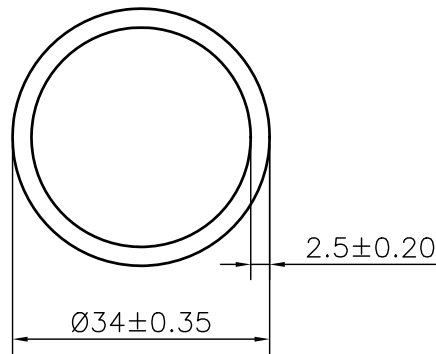

1. STRAIGHTNESS= 1.7mm/M
2. TWIST= 1.7mm/M
3. ANGULARITY= $\pm 2^\circ$
4. FLATNESS= 0.007xWIDTH

Q01792

CONTROLLED COPY



SYMBOL OF QUALITY
AN ISO 9001 COMPANY

JINDAL ALUMINIUM LTD.
BHIWADI-301019 (INDIA)

	NAME	DATE
DRAWN	ASHUTOSH	07-05-2024
CHECKED	PARVESH	13-05-2024
APPROVED	J.N.RAI	13-05-2024
SCALE		1:1
AREA mm ²		247.4
PERIMETER mm.		106.814
WEIGHT kg/m		0.668
DRAWING No.		SECTION No.
P-JAL-B-490		7000002433
G102238		G102238

1. ALL DIMENSIONS ARE IN mm.
2. ROUND OFF ALL SHARP CORNERS WITH 0.40 mm.
3. TOLERANCES WILL BE AS PER BS:EN-755-8 , UNLESS OTHERWISE SPECIFIED

PARTY'S NAME	ATCO ALUMINIUM SYSTEM	
PARTY'S DRAWING No.	AS PER DRAWING	
ALLOY & TEMPER	6005 T6	PRODUCT CODE:-006
		HSN CODE:- 76082000
DESCRIPTION	ROUND TUBE	