

P-JAL-B-834

G103478

FITMENT CHANGED BY CUSTOMER IS VERY TIGHT. SO, MATCHING WITH SECTION NO. 21274 WILL BE AT CUSTOMER END ONLY

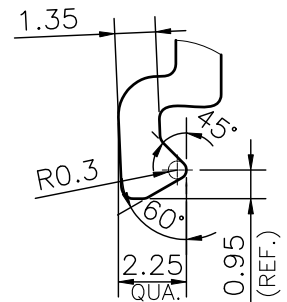
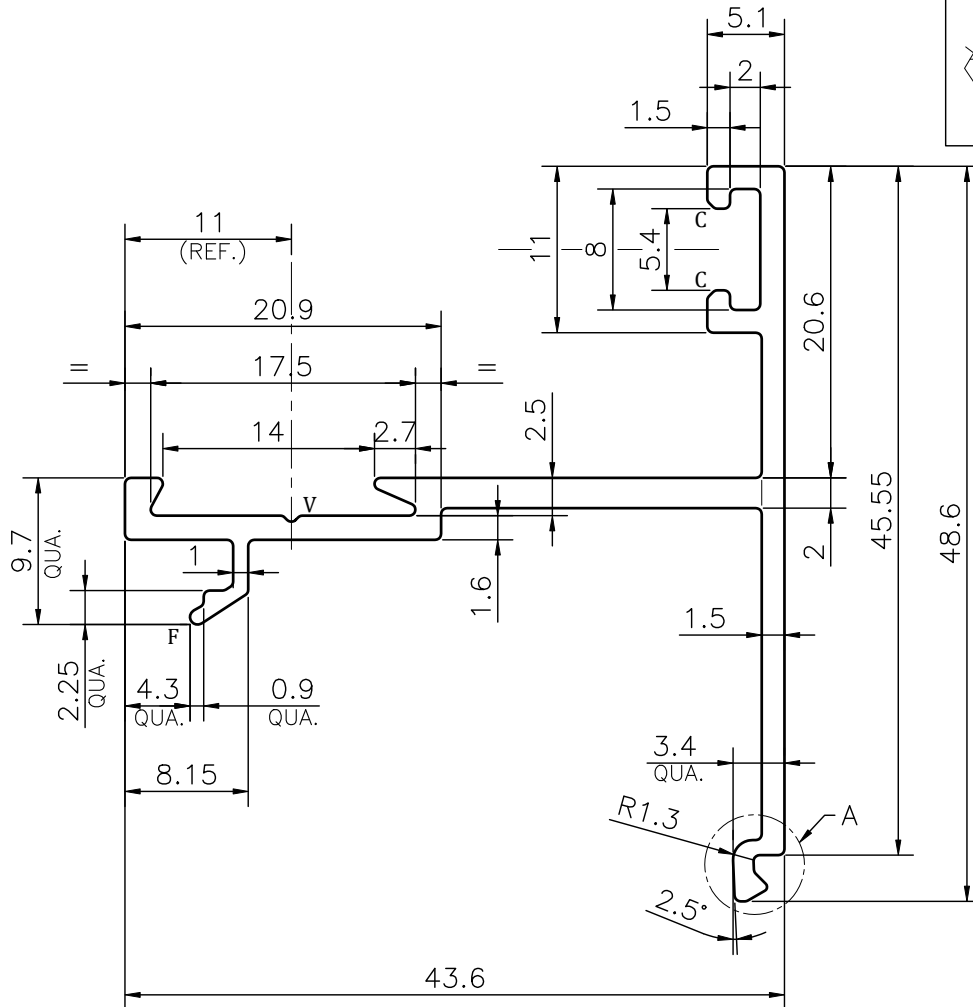
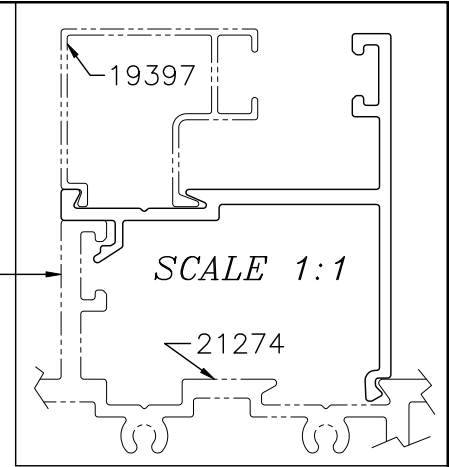

DETAIL A
SCALE 4:1

NOTE:-
F= FULL RADIUS (1 PLACE)
C= 0.5x45° CHAMFER (2 PLACES)
V= 0.4x90° V-GROOVE (1 PLACE)

1. STRAIGHTNESS= 1.7mm/M
2. TWIST= 1.7mm/M
3. ANGULARITY= ±2°
4. FLATNESS= 0.007xWIDTH

Q02589

CONTROLLED COPY



SYMBOL OF QUALITY
AN ISO 9001 COMPANY

JINDAL ALUMINIUM LTD.
BHIWADI-301019 (INDIA)

	NAME	DATE
DRAWN	ASHUTOSH	23-11-2024
CHECKED	PARVESH	24-01-2025
APPROVED	J.N.RAI	24-01-2025
SCALE		2:1
AREA	mm ²	186.024
PERIMETER	mm.	231.47
WEIGHT	kg/m	0.502
DRAWING No.	SECTION No.	
P-JAL-B-834	7000003699	
G103478	G103478	

1. ALL DIMENSIONS ARE IN mm.
2. ROUND OFF ALL SHARP CORNERS WITH 0.40 mm.
3. TOLERANCES WILL BE AS PER BS:EN-755-9 , UNLESS OTHERWISE SPECIFIED

PARTY'S NAME	K.S.V INFRABUILD, NOIDA	
PARTY'S DRAWING No.	AS PER REVISED CAD DRAWING	
ALLOY & TEMPER	6063 T6	PRODUCT CODE:-048
		HSN CODE:- 76042990
DESCRIPTION	WINDOW SECTION -ADD ON	