

P-JAL-B-906

G103537

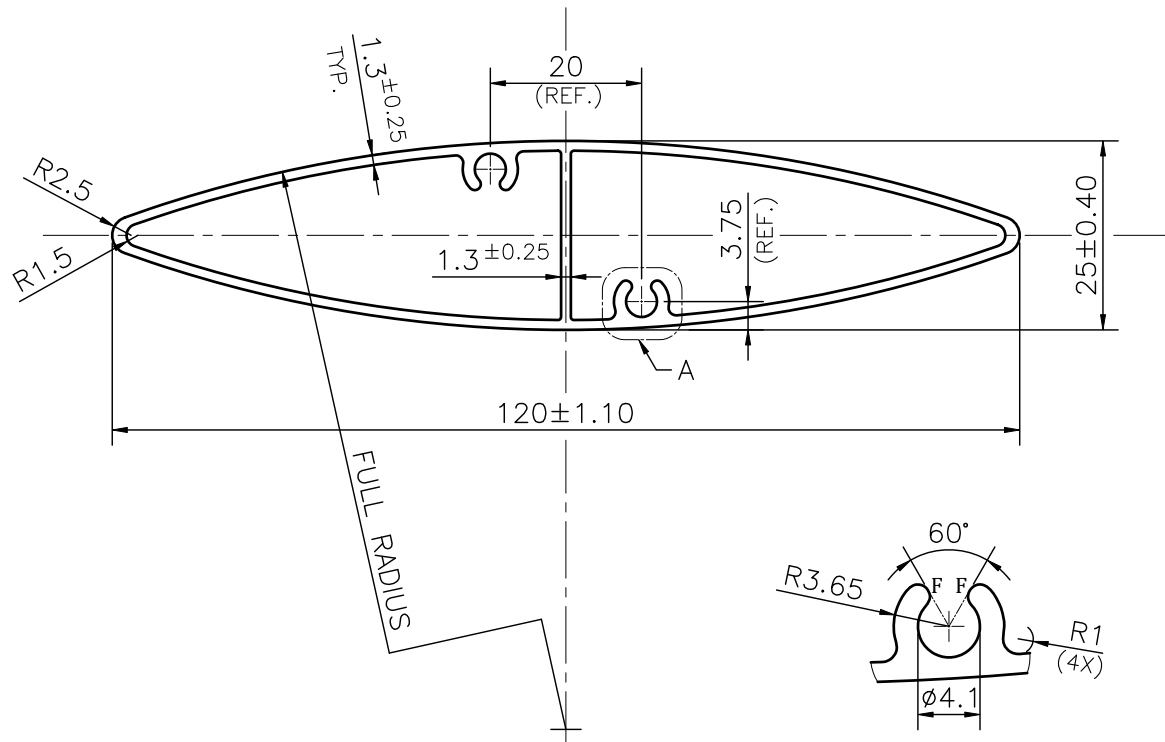

DETAIL A  
SCALE 2:1

NOTE:-

F= FULL RADIUS (4 PLACES)

1. STRAIGHTNESS= 1.7mm/M
2. TWIST= 1.7mm/M
3. ANGULARITY=  $\pm 2^\circ$
4. FLATNESS= 0.007xWIDTH

Q02803

CONTROLLED COPY



SYMBOL OF QUALITY  
AN ISO 9001 COMPANY

**JINDAL ALUMINIUM LTD.**  
**BHIWADI-301019 (INDIA)**

1. ALL DIMENSIONS ARE IN mm.
2. ROUND OFF ALL SHARP CORNERS WITH 0.40 mm.
3. TOLERANCES WILL BE AS PER BS:EN-755-9, UNLESS OTHERWISE SPECIFIED

|                     |  |                     |                      |             |            |
|---------------------|--|---------------------|----------------------|-------------|------------|
| PARTY'S NAME        | NITSON AND AMITSU PRIVATE LIMITED, NEW DELHI |                     | DRAWN                | ASHUTOSH    | 22-01-2025 |
| PARTY'S DRAWING No. | AS PER PROPOSAL DRAWING                      |                     | CHECKED              | PARVESH     | 06-02-2025 |
| ALLOY & TEMPER      | 6063 T6                                      | PRODUCT CODE:-048   | APPROVED             | J.N.RAI     | 06-02-2025 |
| DESCRIPTION         | LOUVER SECTION                               |                     | SCALE                |             | 1:1        |
|                     |  | HSN CODE:- 76042100 | AREA mm <sup>2</sup> |             | 388.064    |
|                     |  |                     | PERIMETER mm.        |             | 250.318    |
|                     |  |                     | WEIGHT kg/m          |             | 1.048      |
|                     |  |                     | DRAWING No.          | SECTION No. |            |
|                     |  |                     | P-JAL-B-906          | 7000003718  |            |
|                     |  |                     | G103537              | G103537     |            |
|                     |  |                     |                      |             |            |
|                     |  |                     |                      |             |            |