

P-JAL-B-957

G103627

G103628

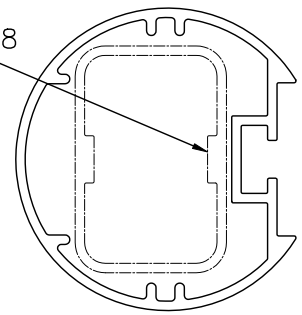

**MATCHING
SCALE 1:2**

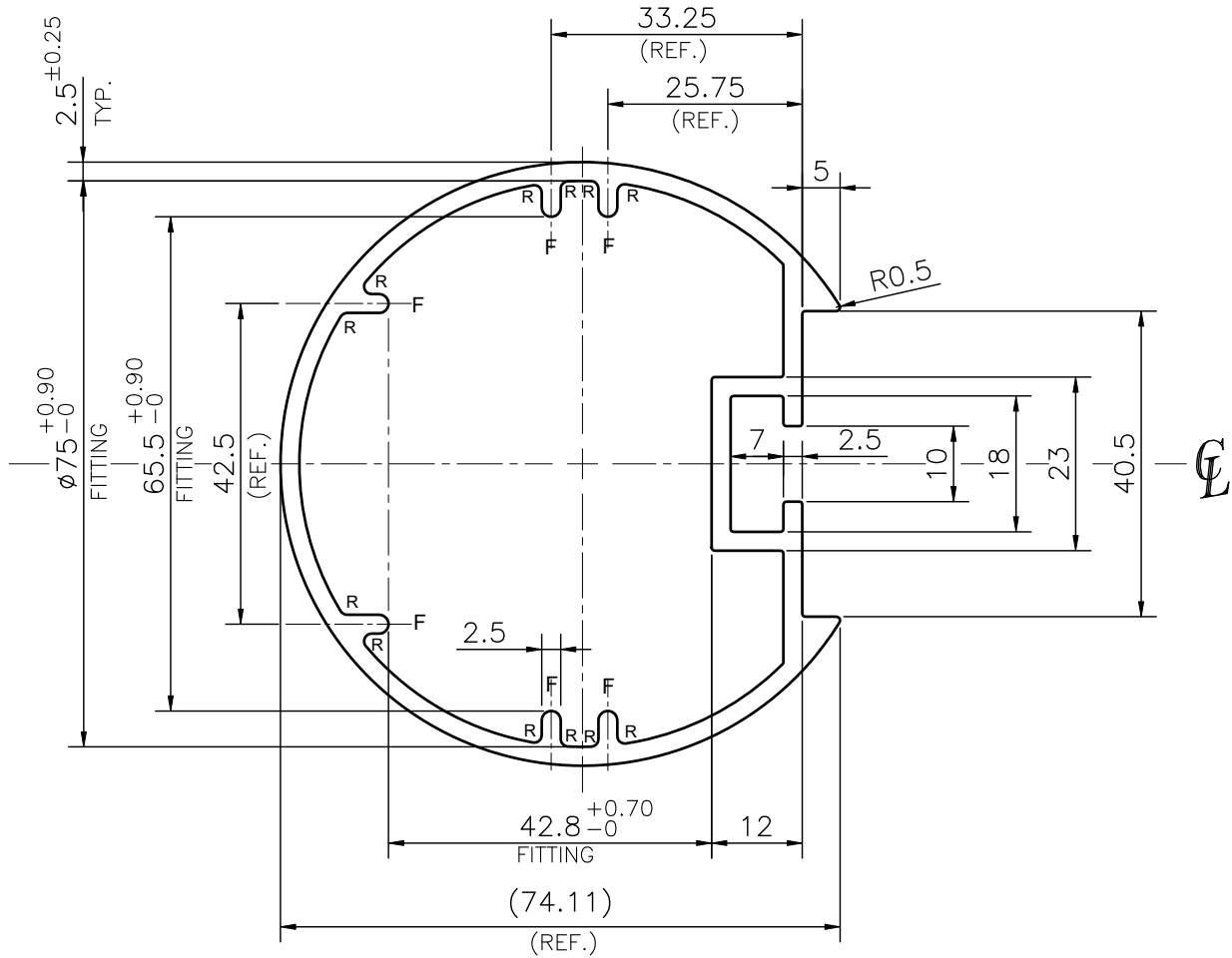

NOTE:-

**R= 1.0 RADIUS (12 PLACES)
F= FULL RADIUS (6 PLACES)**

1. STRAIGHTNESS= 1.7mm/M
2. TWIST= 1.7mm/M
3. ANGULARITY= ±2°
4. FLATNESS= 0.007xWIDTH

Q03022

CONTROLLED COPY



SYMBOL OF QUALITY
AN ISO 9001 COMPANY

JINDAL ALUMINIUM LTD.
BHIWADI-301019 (INDIA)

	NAME	DATE
DRAWN	ASHUTOSH	14-02-2025
CHECKED	PARVESH	03-03-2025
APPROVED	J.N.RAI	03-03-2025

1. ALL DIMENSIONS ARE IN mm.
2. ROUND OFF ALL SHARP CORNERS WITH 0.40 mm.
3. TOLERANCES WILL BE AS PER BS:EN-755-9 , UNLESS OTHERWISE SPECIFIED

SCALE	1:1
AREA mm ²	774.886
PERIMETER mm.	291.988
WEIGHT kg/m	2.092

PARTY'S NAME	SPORTS & SPORTS INTERNATIONAL, MEERUT	
PARTY'S DRAWING No.	AS PER PROPOSAL DRAWING	
ALLOY & TEMPER	6063 T6	PRODUCT CODE:-085
		HSN CODE:- 76042100
DESCRIPTION	INDUSTRIAL SECTION	

DRAWING No.	SECTION No.
P-JAL-B-957	7000003859
G103627	G103627