

P-14793

S4510

EXPOSED SURFACE

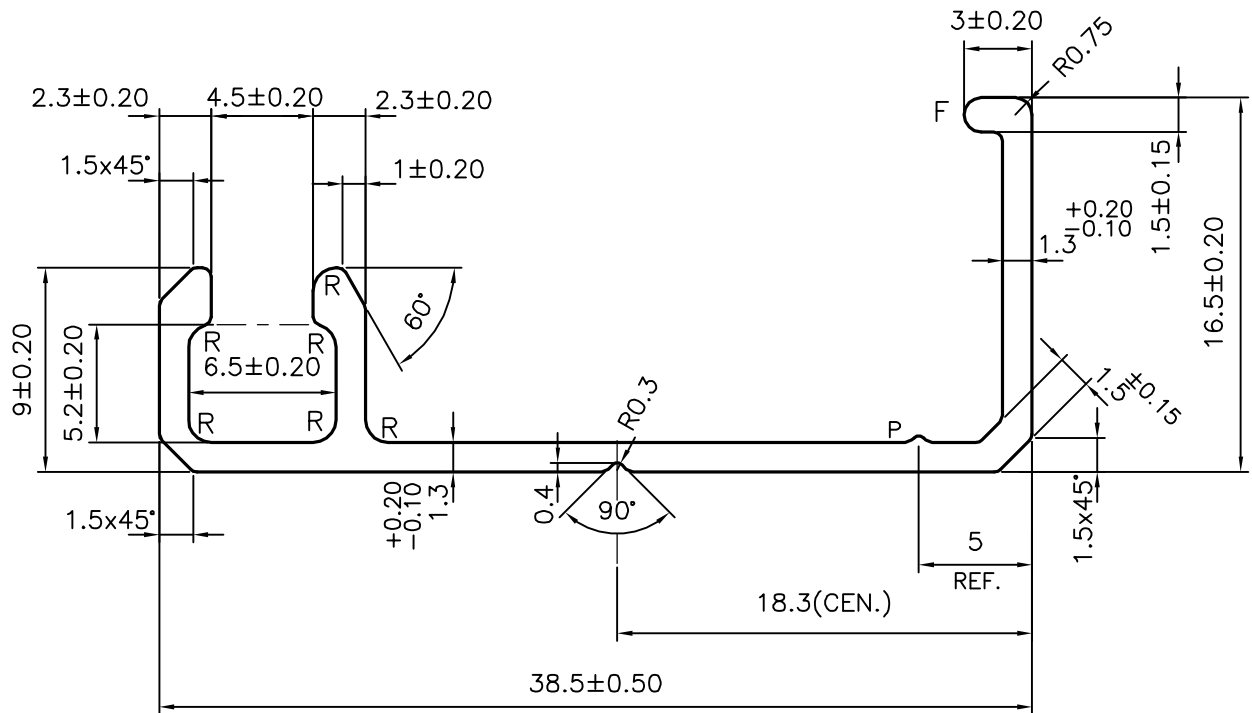
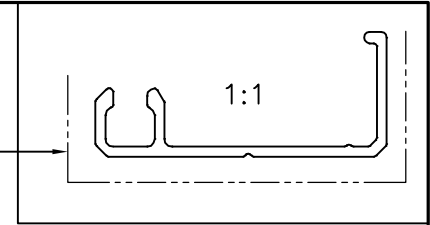

P = PIP 0.3x90°
 F = FULL RADIUS
 R = 1.0 RADIUS (6)



SYMBOL OF QUALITY
 AN ISO 9001 COMPANY

JINDAL ALUMINIUM LTD.
 BANGALORE-560073 (INDIA)

	NAME	DATE
DRAWN	J.P.KAUSHIK	23-06-2015
CHECKED		
APPROVED	S.S.GARG	02-07-2015

1. ALL DIMENSIONS ARE IN mm.
2. ROUND OFF ALL SHARP CORNERS WITH 0.40 mm.
3. TOLERANCES WILL BE AS PER IS:3965-1981 UNLESS OTHERWISE SPECIFIED

SCALE	3:1
AREA mm ²	93.997
PERIMETER mm.	140.385
WEIGHT kg/m	0.254

PARTY'S NAME: G.V. ENTERPRISES, BANGALORE

PARTY'S DRAWING No.: AS PER DRAWING

ALLOY & TEMPER: 6063 T6

DESCRIPTION: SOLAR SECTION

DRAWING No.	SECTION No.
P-14793	-
S4510	S4510