

P-15133-1

S4675

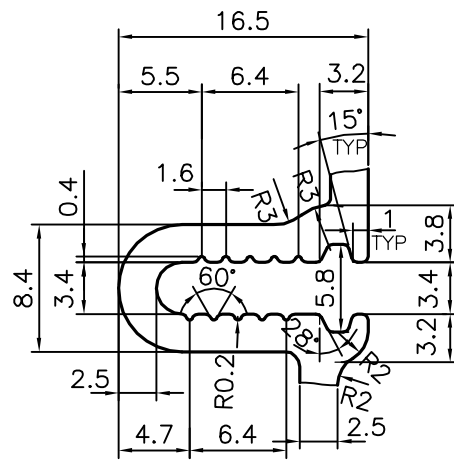

DETAIL OF "C"  
SCALE 2:1

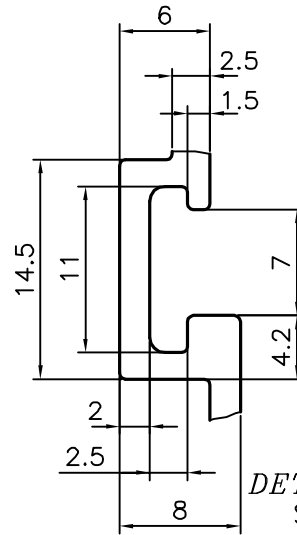

DETAIL OF "B"  
SCALE 2:1

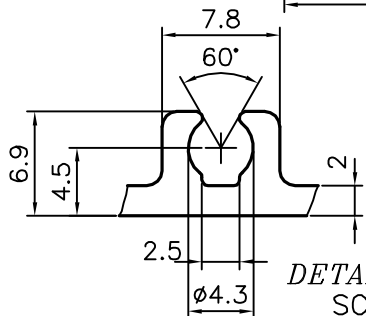
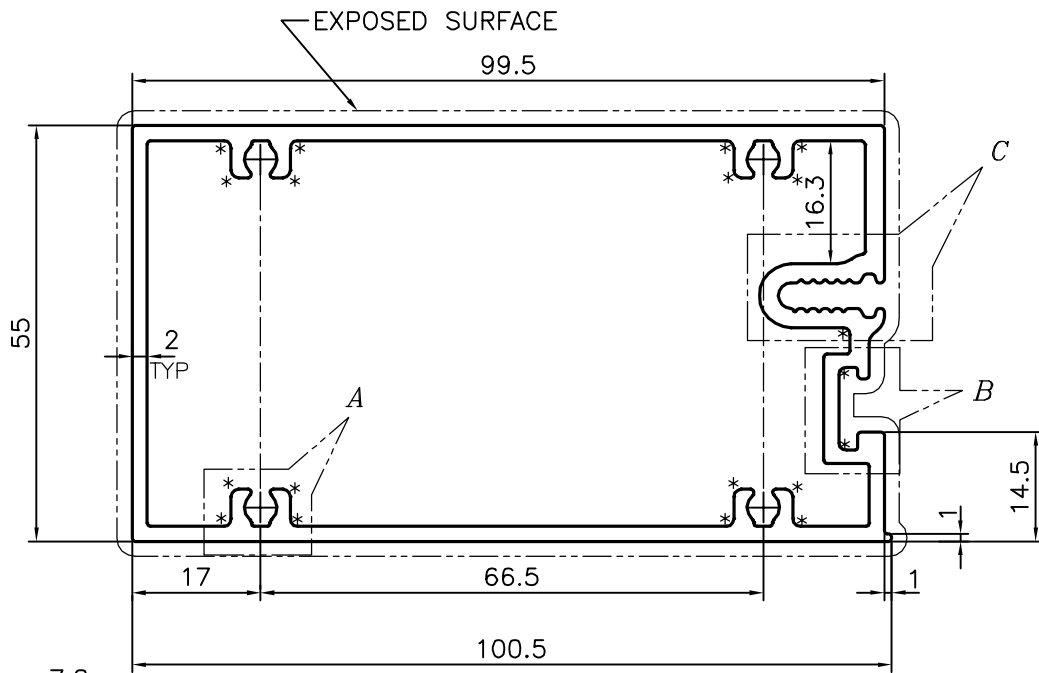

DETAIL OF "A"  
SCALE 2:1

AVERAGE THICKNESS HAS TO BE MAINTAINED WITH IN  $\pm 0.20$  mm. OF THE NOMINAL VALUE.

\* = 1.0 RADIUS (19 PLACES)



SYMBOL OF QUALITY  
AN ISO 9001 COMPANY

**JINDAL ALUMINIUM LTD.**  
BANGALORE-560073 (INDIA)

	NAME	DATE
DRAWN	J.P.KAUSHIK	15-09-2015
CHECKED		
APPROVED	S.S.GARG	21-09-2015
SCALE		1:1
AREA	mm <sup>2</sup>	793.229
PERIMETER	mm.	359.064
WEIGHT	kg/m	2.142
DRAWING No.	SECTION No.	
P-15133-1	-	
S4675	S4675	

- ALL DIMENSIONS ARE IN mm.
- ROUND OFF ALL SHARP CORNERS WITH 0.40 mm.
- TOLERANCES WILL BE AS PER IS:6477-1983, UNLESS OTHERWISE SPECIFIED

PARTY'S NAME	OMKAR REALTORS & DEVELOPERS PVT. LTD., MUMBAI
PARTY'S DRAWING No.	AP-1592
ALLOY & TEMPER	6063 T6
DESCRIPTION	CURTAIN WALL SECTION