

P-15785-1

S4953

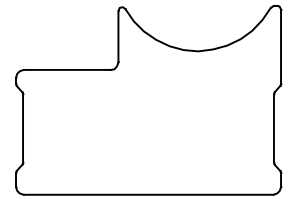

1:1

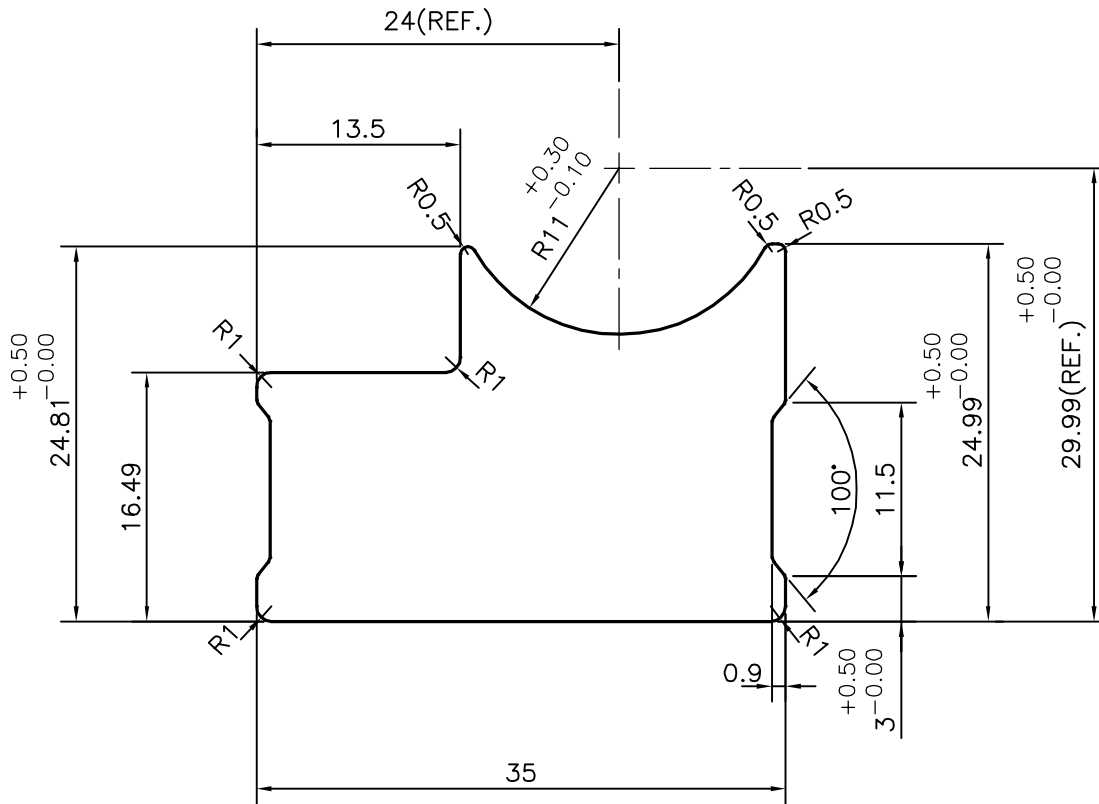

SYMBOL OF QUALITY
AN ISO 9001 COMPANY

JINDAL ALUMINIUM LTD.
BANGALORE-560073 (INDIA)

| | NAME | DATE |
|----------|-------------|------------|
| DRAWN | J.P.KAUSHIK | 19-04-2016 |
| CHECKED | | |
| APPROVED | S.S. GARG | 27-05-2016 |

1. ALL DIMENSIONS ARE IN mm.
2. ROUND OFF ALL SHARP CORNERS WITH 0.40 mm.
3. TOLERANCES WILL BE AS PER,IS:3965-1981 UNLESS OTHERWISE SPECIFIED

| | |
|----------------------|---------|
| SCALE | 2:1 |
| AREA mm ² | 656.455 |
| PERIMETER mm. | 123.213 |
| WEIGHT kg/m | 1.772 |

| | |
|---------------------|--|
| PARTY'S NAME | JAGDEV ENGINEERING SOLUTIONS PVT. LTD., MOHALI |
| PARTY'S DRAWING No. | WTP 8921 |
| ALLOY & TEMPER | 6063 T6 |
| DESCRIPTION | CONNECTOR MODULE-8 UCR CONDENSER |

| DRAWING No. | SECTION No. |
|-------------|-------------|
| P-15785-1 | - |
| S4953 | S4953 |
| | |
| | |