

P-16458-1

S5293

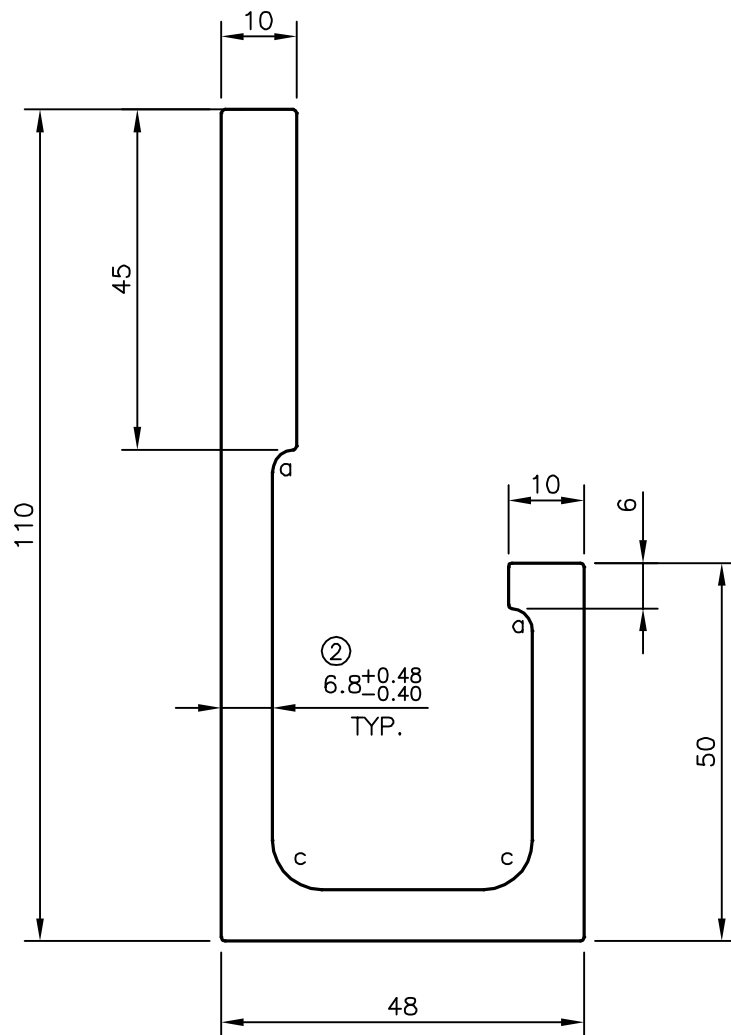

② ISSUE2 : TOLERANCE ADDED, AS PER CUSTOMER E-MAIL DATED 04-03-2017

a : RADIUS 3.00 mm (2 PLACES)

c : RADIUS 6.50 mm (2 PLACES)

TOLERANCES ON OVERALL WIDTHS & WIDTHS ACROSS FLATS OF BARS, & REGULAR SECTIONS

UPTO 6.40mm - ±0.20	UPTO 32.0mm - ±0.38	UPTO 120.0mm - ±0.85	1. STRAIGHTNESS=1.7mm/M 2. TWIST=1.7mm/M 3. ANGULARITY= ±2° 4. FLATNESS =0.007xWIDTH
UPTO 10.0mm - ±0.23	UPTO 50.0mm - ±0.46	UPTO 160.0mm - ±1.02	
UPTO 12.0mm - ±0.25	UPTO 60.0mm - ±0.53	UPTO 200.0mm - ±1.14	
UPTO 16.0mm - ±0.28	UPTO 80.0mm - ±0.69	UPTO 250.0mm - ±1.40	
UPTO 25.0mm - ±0.30	UPTO 100.0mm - ±0.75	UPTO 300.0mm - ±1.65	



SYMBOL OF QUALITY  
AN ISO 9001 COMPANY

**JINDAL ALUMINIUM LTD.**  
BANGALORE-560073 (INDIA)

	NAME	DATE
DRAWN	KIRAN	23-01-2017
CHECKED		
APPROVED	B.NATARAJ	09-02-2017
SCALE	1:1	
AREA mm <sup>2</sup>	1506.615	
PERIMETER mm.	405.353	
WEIGHT kg/m	4.068	
DRAWING No.	SECTION No.	
P-16458-1		
S5293	S5293(ISSUE-2)	

1. ALL DIMENSIONS ARE IN mm.
2. ROUND OFF ALL SHARP CORNERS WITH 0.50 mm.
3. TOLERANCES WILL BE AS PER IS:3965-1981, UNLESS OTHERWISE SPECIFIED

PARTY'S NAME	JASH ENGINEERING LTD., INDORE
PARTY'S DRAWING No.	JESW/SG/GENERAL/1473 & REQUIREMENT
ALLOY & TEMPER	6061 T6, ASTM B221
DESCRIPTION	TOP FRAME MEMBER SECTION