

P-16902

S5365

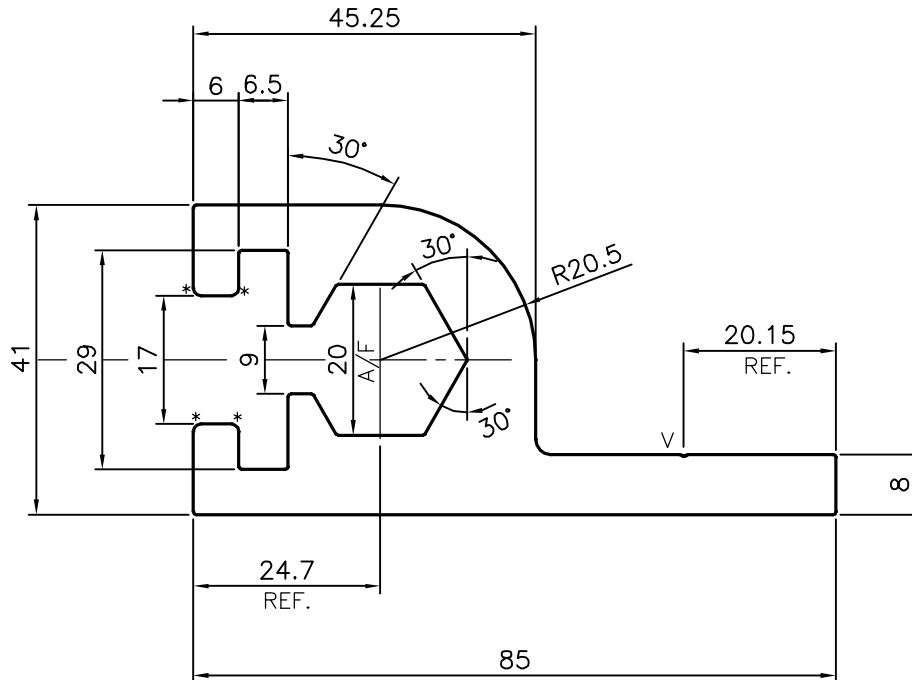

\* = RADIUS 1.0 (4 PLACES)

V = VEE GROOVE 0.3x90° (1 PLACE)

## TOLERANCES ON OVERALL WIDTHS &amp; WIDTHS ACROSS FLATS OF BARS, &amp; REGULAR SECTIONS

UPTO 6.40mm - ±0.20	UPTO 32.0mm - ±0.38	UPTO 120.0mm - ±0.85	UPTO 320.00mm - ±1.70
UPTO 10.0mm - ±0.23	UPTO 50.0mm - ±0.46	UPTO 160.0mm - ±1.02	
UPTO 12.0mm - ±0.25	UPTO 60.0mm - ±0.53	UPTO 200.0mm - ±1.14	
UPTO 16.0mm - ±0.28	UPTO 80.0mm - ±0.69	UPTO 250.0mm - ±1.40	
UPTO 25.0mm - ±0.30	UPTO 100.0mm - ±0.75	UPTO 300.0mm - ±1.65	



SYMBOL OF QUALITY  
AN ISO 9001 COMPANY

**JINDAL ALUMINIUM LTD.**  
BANGALORE-560073 (INDIA)

- ALL DIMENSIONS ARE IN mm.
- ROUND OFF ALL SHARP CORNERS WITH 0.40 mm.
- TOLERANCES WILL BE AS PER IS:3965-1981 UNLESS OTHERWISE SPECIFIED

PARTY'S NAME	GLOBAL SYNDICATE, BANGALORE	DRAWN	J.P.KAUSHIK	DATE	23-03-2017
PARTY'S DRAWING No.	AS PER DRAWING-SOB/LULU/SE108	CHECKED			
ALLOY & TEMPER	6063 T6	APPROVED	B.NATARAJ		20-04-2017
DESCRIPTION	CURTAIN WALL SECTION	SCALE			1:1
		AREA mm <sup>2</sup>			1428.375
		PERIMETER mm.			344.188
		WEIGHT kg/m			3.857
		DRAWING No.	P-16902	SECTION No.	-
			S5365		S5365