

DETAIL OF "A"  
SCALE 4:1

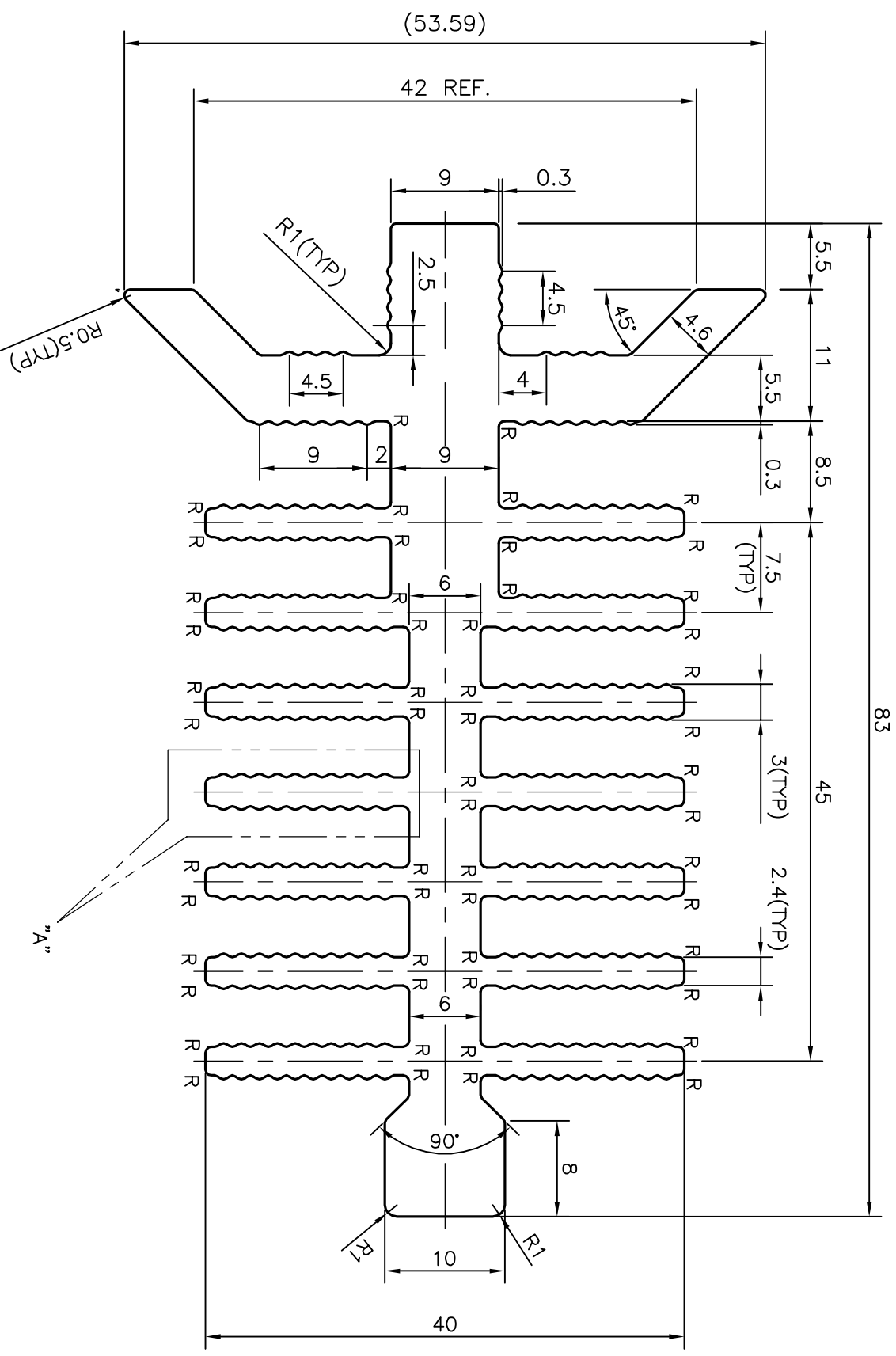
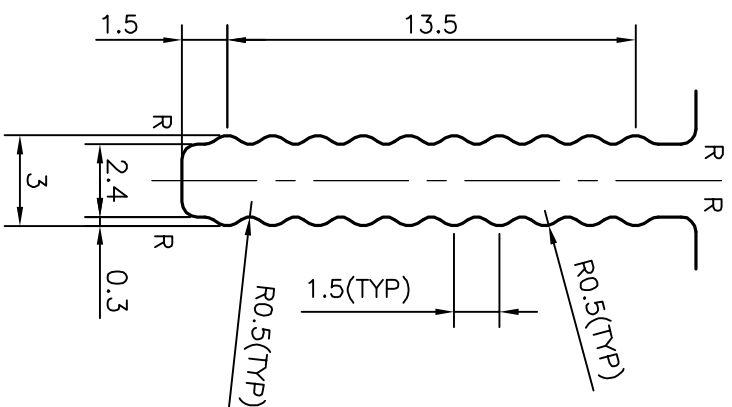

R = R0.50 mm (58 PLACES)

TOLERANCES ON OVERALL WIDTHS & WIDTHS ACROSS FLATS OF BARS, & REGULAR SECTIONS

UPTO 6.40mm - ±0.20	UPTO 32.0mm - ±0.38	UPTO 120.0mm - ±0.85	UPTO 320.00mm - ±1.70
UPTO 10.0mm - ±0.23	UPTO 50.0mm - ±0.46	UPTO 160.0mm - ±1.02	
UPTO 12.0mm - ±0.25	UPTO 60.0mm - ±0.53	UPTO 200.0mm - ±1.14	
UPTO 16.0mm - ±0.28	UPTO 80.0mm - ±0.69	UPTO 250.0mm - ±1.40	
UPTO 25.0mm - ±0.30	UPTO 100.0mm - ±0.75	UPTO 300.0mm - ±1.65	

<p>SYMBOL OF QUALITY AN ISO 9001 COMPANY</p>	<p><b>JINDAL ALUMINIUM LTD.</b> BANGALORE-560073 (INDIA)</p>		<p>NAME: J.P. KAUSHIK</p> <p>DATE: 08-08-2017</p>
	<p>1. ALL DIMENSIONS ARE IN mm. 2. ROUND OFF ALL SHARP CORNERS WITH 0.40 mm. 3. TOLERANCES WILL BE AS PER IS:3965-1981 UNLESS OTHERWISE SPECIFIED</p>		<p>CHECKED:</p> <p>APPROVED: <b>B.NATARAJA</b> 22-08-2017</p>
PARTY'S NAME	TUMKUR PRECISION PRESSING WORKS, TUMKUR	SCALE	2:1
PARTY'S DRAWING No.	PHOESINK02-MECH9XX	AREA mm <sup>2</sup>	1493.578
ALLOY & TEMPER	HE9 WP	PERIMETER mm.	776.013
DESCRIPTION	HEAT SINK SECTION	WEIGHT kg/m	4.033
		DRAWING No.	P-17372-1
		SECTION No.	S5482

