

P-18217

S5857

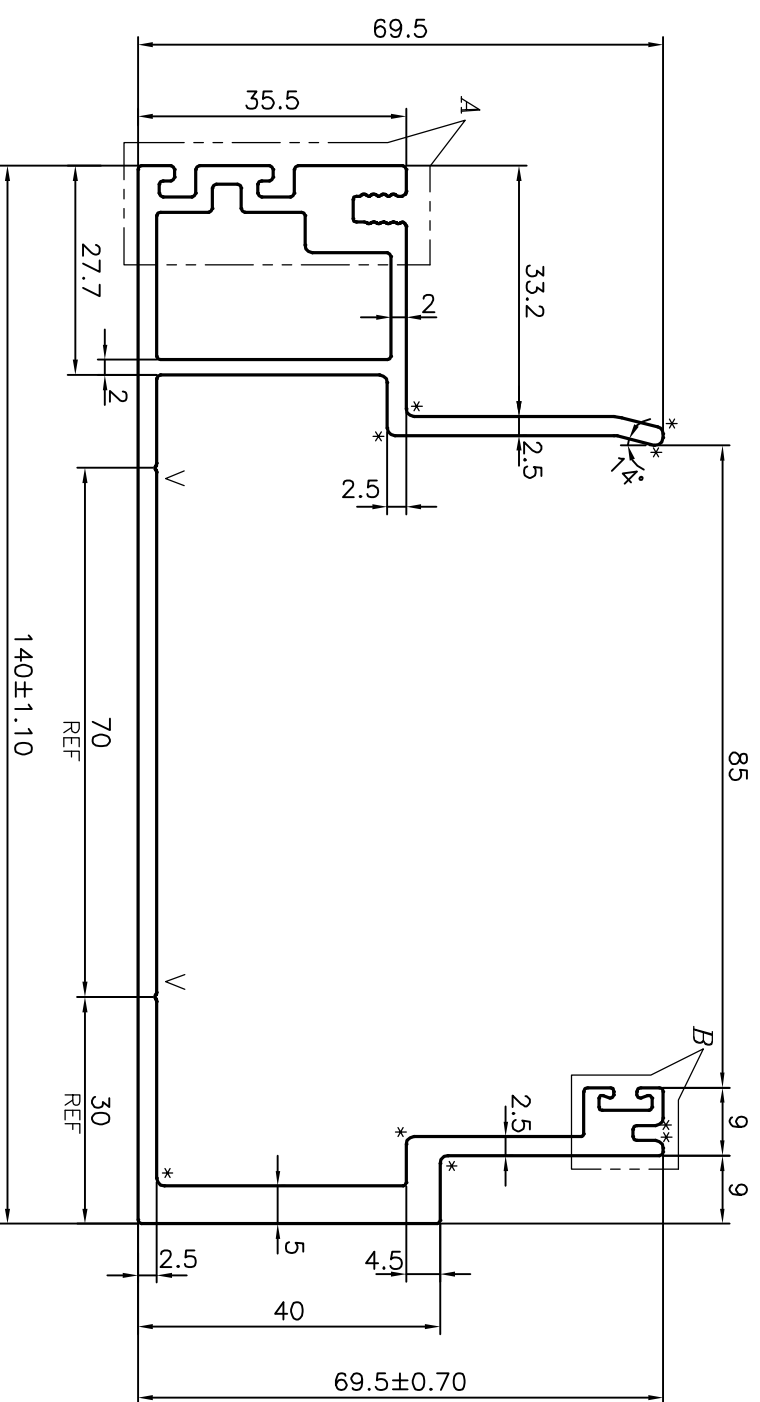

* = RADIUS 1 mm. (9 PLACES)
V = VEE GROOVE 0.3x90° (2 PLACES)

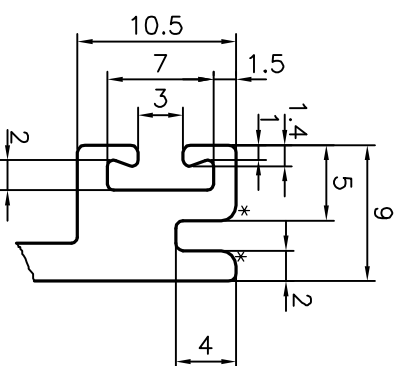
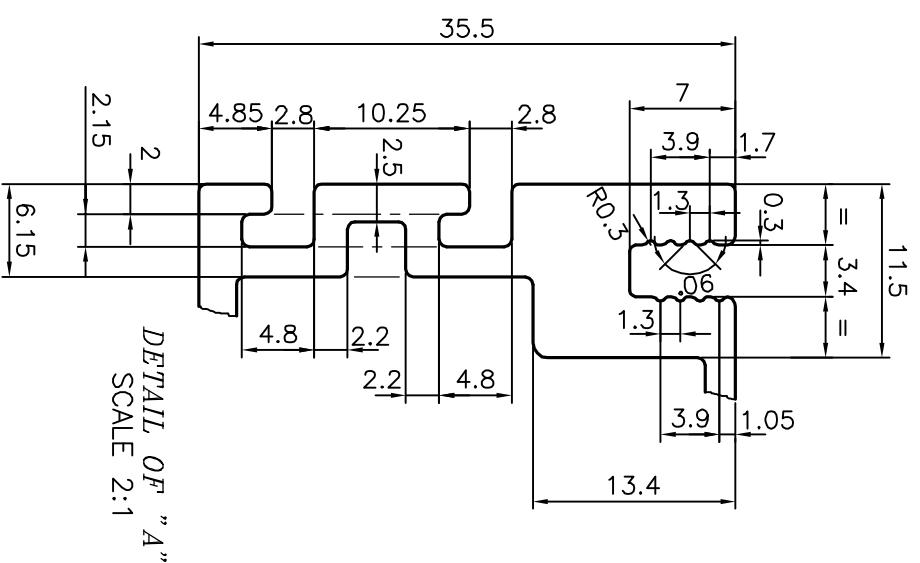
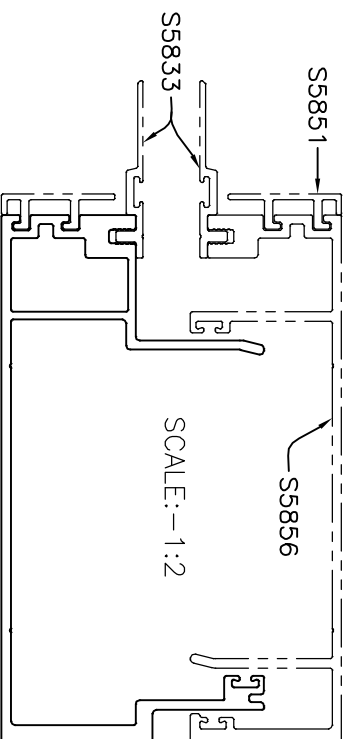

TOLERANCES ON OVERALL WIDTHS & WIDTHS ACROSS FLATS OF BARS, & REGULAR SECTIONS

UPTO 6.40mm - ±0.20	UPTO 32.0mm - ±0.38	UPTO 120.0mm - ±0.85
UPTO 10.0mm - ±0.23	UPTO 50.0mm - ±0.46	UPTO 160.0mm - ±1.02
UPTO 12.0mm - ±0.25	UPTO 60.0mm - ±0.53	UPTO 200.0mm - ±1.14
UPTO 16.0mm - ±0.28	UPTO 80.0mm - ±0.69	UPTO 250.0mm - ±1.40
UPTO 25.0mm - ±0.30	UPTO 100.0mm - ±0.75	UPTO 300.0mm - ±1.65

1. STRAIGHTNESS=1.7mm/M
2. TWIST=1.7mm/M
3. FLATNESS =0.003xWIDTH

<p>JINDAL SYMBOL OF QUALITY AN ISO 9001 COMPANY</p>		<p>JINDAL ALUMINIUM LTD. BANGALORE-560073 (INDIA)</p>	
<p>1. ALL DIMENSIONS ARE IN mm. 2. ROUND OFF ALL SHARP CORNERS WITH 0.40 mm. 3. TOLERANCES WILL BE AS PER IS:6477-1983 , UNLESS OTHERWISE SPECIFIED</p>		<p>DRAWN J.P. KAVSHIK 15-05-2018 CHECKED APPROVED B. NATARAJA 28-05-2018</p>	
<p>PARTY'S NAME GLASS WALL SYSTEMS INDIA PVT. LTD., MUMBAI</p>		<p>SCALE 1:1</p>	
<p>PARTY'S DRAWING No. AS PER DRAWING-95159</p>		<p>AREA mm² 1086.98</p>	
<p>ALLOY & TEMPER 6063 T6</p>		<p>PERIMETER mm. 647.107</p>	
<p>DESCRIPTION CURTAIN WALL SECTION</p>		<p>WEIGHT kg/m 2.935</p>	
<p>DRAWING No. P-18217</p>		<p>SECTION No. -</p>	
<p>S5857</p>		<p>S5857</p>	