

P-19567

S6328

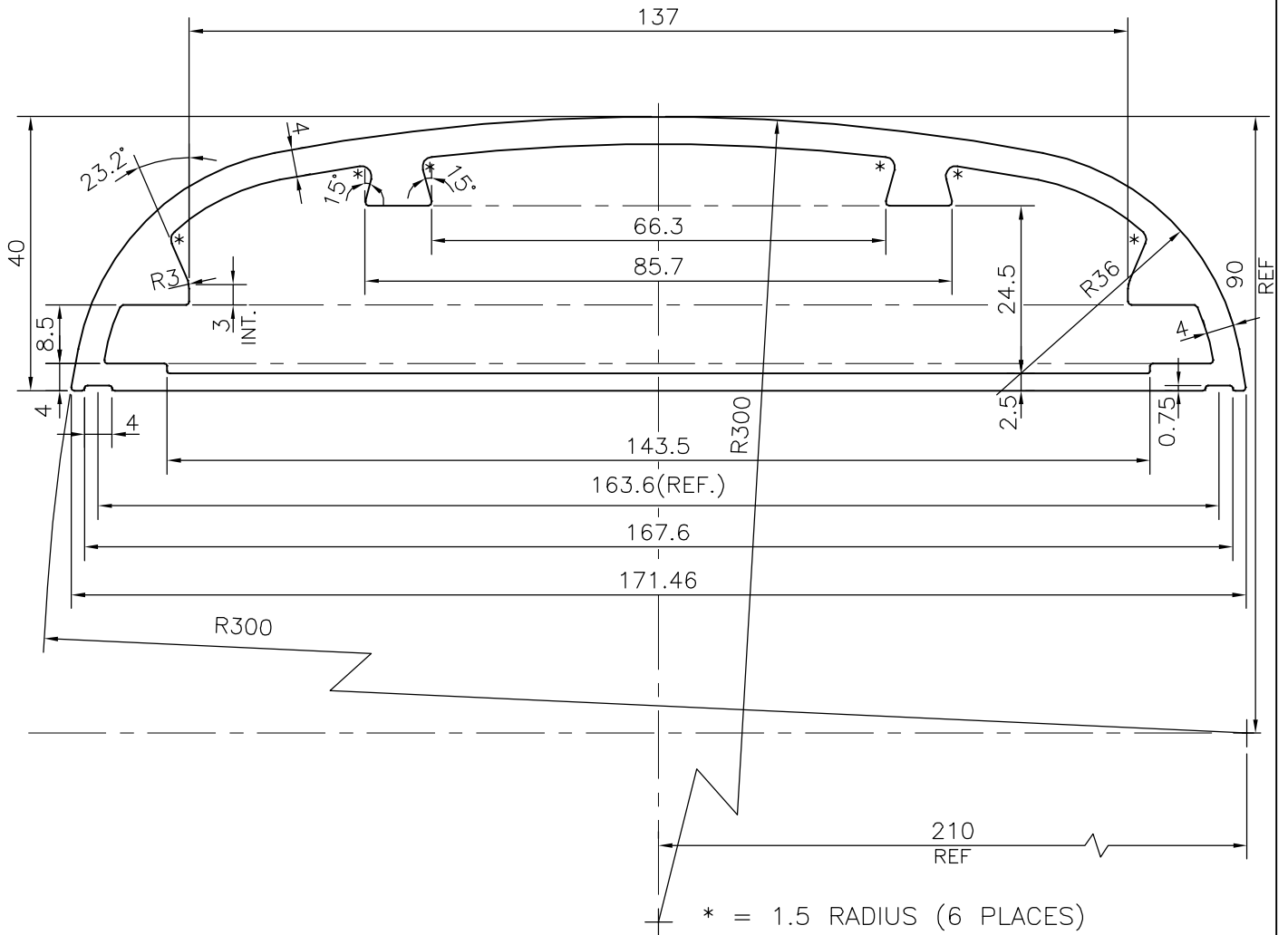

**JINDAL ALUMINIUM LTD.**  
 BANGALORE-560073 (INDIA)

	NAME	DATE
DRAWN	J.P.KAUSHIK	23-05-2019
CHECKED		
APPROVED	B.NATARAJA	01-07-2019
SCALE		1:1
AREA mm <sup>2</sup>		1479.288
PERIMETER mm.		383.922
WEIGHT kg/m		3.994
DRAWING No.	SECTION No.	
P-19567	-	
S6328	S6328	

1. ALL DIMENSIONS ARE IN mm.
2. ROUND OFF ALL SHARP CORNERS WITH 0.40 mm.
3. TOLERANCES WILL BE AS PER IS:6477-1983 , UNLESS OTHERWISE SPECIFIED

PARTY'S NAME	CAMTEK SERVICES, BANGALORE
PARTY'S DRAWING No.	AS PER DRAWING
ALLOY & TEMPER	6063 T6
DESCRIPTION	FRONT ENCLOSURE SECTION