

P-19736

S6348

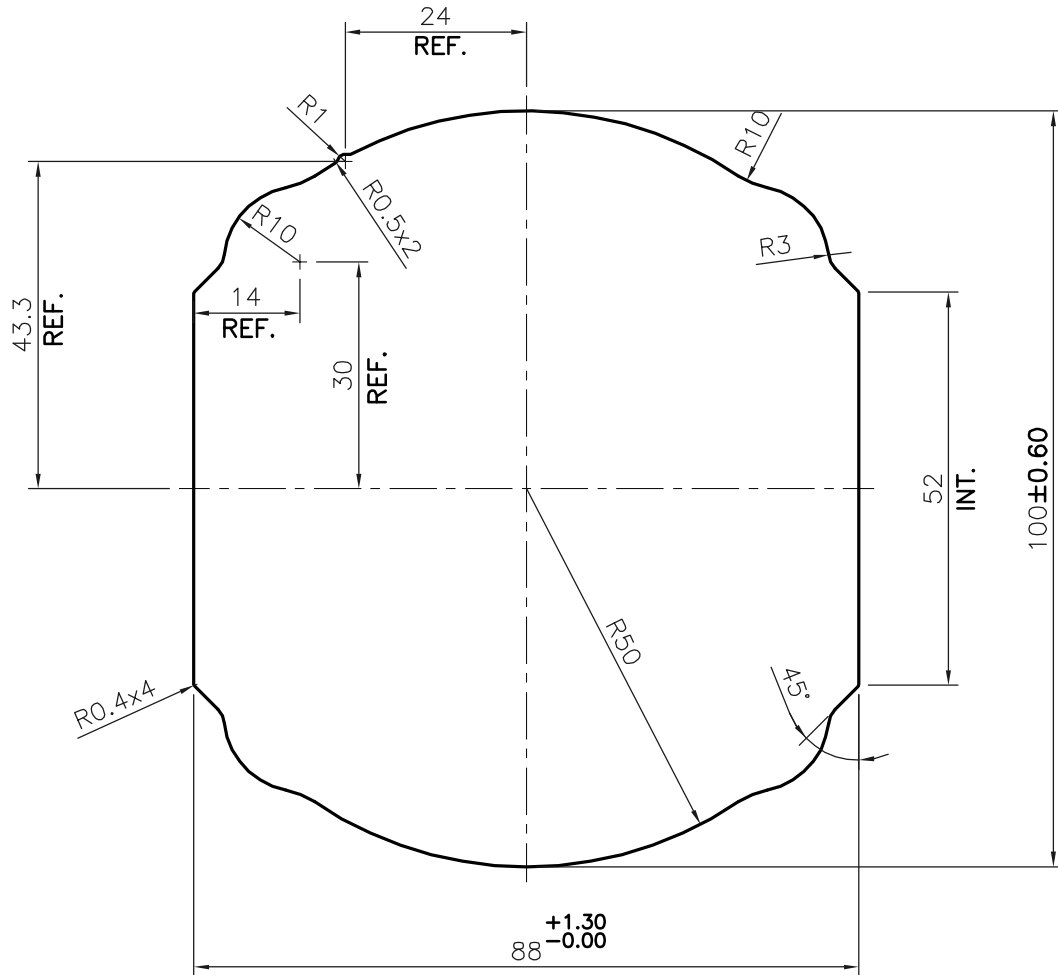

SYMBOL OF QUALITY
AN ISO 9001 COMPANY

JINDAL ALUMINIUM LTD.
BANGALORE-560073 (INDIA)

	NAME	DATE
DRAWN	DARPAN	05-07-2019
CHECKED		
APPROVED	B.NATARAJA	08-07-2019

1. ALL DIMENSIONS ARE IN mm.
2. ROUND OFF ALL SHARP CORNERS WITH 0.40 mm.
3. TOLERANCES WILL BE AS PER IS:3965-1981 UNLESS OTHERWISE SPECIFIED

SCALE	1:1
AREA mm ²	7582.701
PERIMETER mm.	317.509
WEIGHT kg/m	20.473

PARTY'S NAME: MIVIN ENGG. TECHNOLOGIES PRIVATE LIMITED, RAMANAGARA

PARTY'S DRAWING No.: R 002 G11 609

ALLOY & TEMPER: 6082 T6

DESCRIPTION: PUMP BODY SECTION

DRAWING No.	SECTION No.
P-19736	-
S6348	S6348