

P-20148

S6484

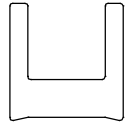

1:1

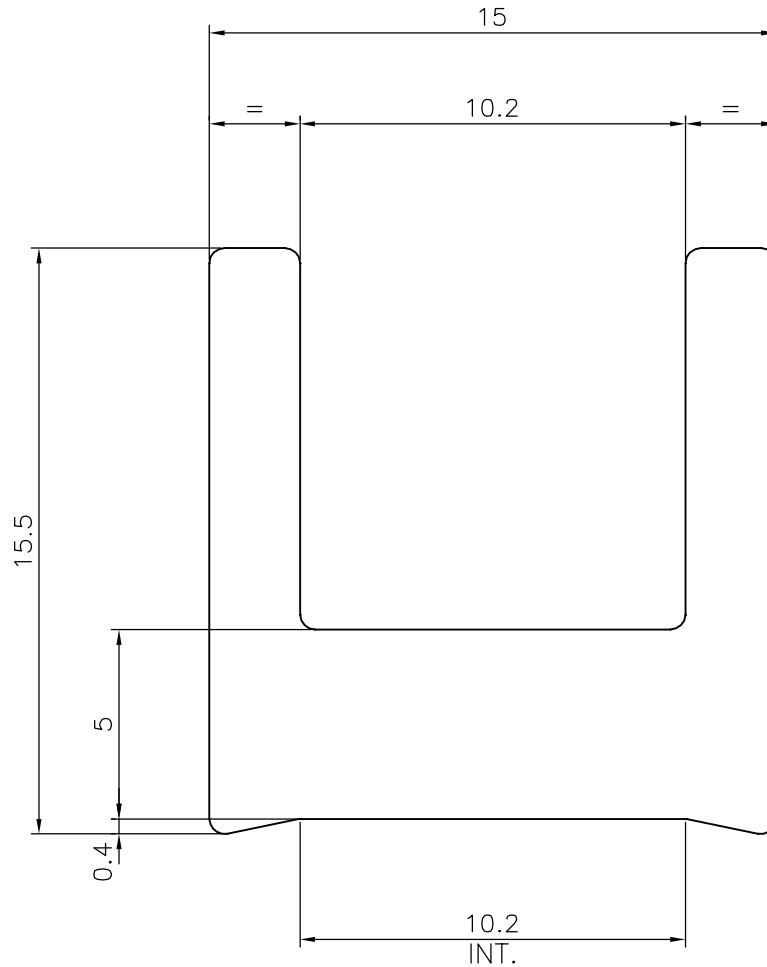

TOLERANCES ON OVERALL WIDTHS & WIDTHS ACROSS FLATS OF BARS, & REGULAR SECTIONS

| | | | |
|--------------------------|---------------------------|---------------------------|----------------------------|
| UPTO 6.40mm - ± 0.20 | UPTO 32.0mm - ± 0.38 | UPTO 120.0mm - ± 0.85 | UPTO 320.00mm - ± 1.70 |
| UPTO 10.0mm - ± 0.23 | UPTO 50.0mm - ± 0.46 | UPTO 160.0mm - ± 1.02 | |
| UPTO 12.0mm - ± 0.25 | UPTO 60.0mm - ± 0.53 | UPTO 200.0mm - ± 1.14 | |
| UPTO 16.0mm - ± 0.28 | UPTO 80.0mm - ± 0.69 | UPTO 250.0mm - ± 1.40 | |
| UPTO 25.0mm - ± 0.30 | UPTO 100.0mm - ± 0.75 | UPTO 300.0mm - ± 1.65 | |



SYMBOL OF QUALITY
AN ISO 9001 COMPANY

JINDAL ALUMINIUM LTD.
BANGALORE-560073 (INDIA)

| | NAME | DATE |
|----------|-------------|------------|
| DRAWN | J.P.KAUSHIK | 14-09-2019 |
| CHECKED | | |
| APPROVED | B.NATARAJA | 21-09-2019 |

1. ALL DIMENSIONS ARE IN mm.
2. ROUND OFF ALL SHARP CORNERS WITH 0.40 mm.
3. TOLERANCES WILL BE AS PER IS:3965-1981 , UNLESS OTHERWISE SPECIFIED

| | |
|----------------------|---------|
| SCALE | 5:1 |
| AREA mm ² | 124.479 |
| PERIMETER mm. | 79.906 |
| WEIGHT kg/m | 0.336 |

PARTY'S NAME ROYAL ENTERPRISES, SALEM

PARTY'S DRAWING No. AS PER SAMPLE

ALLOY & TEMPER 6063 T6

DESCRIPTION MISC. CHANNEL

| DRAWING No. | SECTION No. |
|-------------|-------------|
| P-20148 | - |
| S6484 | S6484 |