

P-20835

S6785

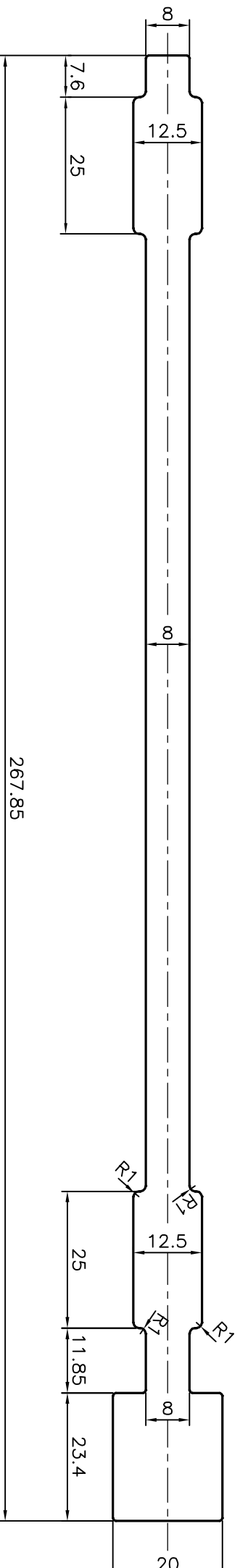

TOLERANCES ON OVERALL WIDTHS & WIDTHS ACROSS FLATS OF BARS, & REGULAR SECTIONS		
UPTO 6.40mm - ±0.20	UPTO 32.0mm - ±0.38	UPTO 120.0mm - ±0.85
UPTO 10.0mm - ±0.23	UPTO 50.0mm - ±0.46	UPTO 160.0mm - ±1.02
UPTO 12.0mm - ±0.25	UPTO 60.0mm - ±0.53	UPTO 200.0mm - ±1.14
UPTO 16.0mm - ±0.28	UPTO 80.0mm - ±0.69	UPTO 250.0mm - ±1.40
UPTO 25.0mm - ±0.30	UPTO 100.0mm - ±0.75	UPTO 300.0mm - ±1.65
		UPTO 320.00mm - ±1.70

**JINDAL**  
 SYMBOL OF QUALITY  
 AN ISO 9001 COMPANY

**JINDAL ALUMINIUM LTD.**  
 BANGALORE-560073 (INDIA)

1. ALL DIMENSIONS ARE IN mm.  
 2. ROUND OFF ALL SHARP CORNERS WITH 0.40 mm.  
 3. TOLERANCES WILL BE AS PER IS:3965-1981 UNLESS OTHERWISE SPECIFIED

PARTY'S NAME	GLAZIUM FACADES PVT. LTD., PUNE	SCALE	1:1
PARTY'S DRAWING No.	AS PER DRAWING	AREA mm <sup>2</sup>	2648.385
ALLOY & TEMPER	6063 T6	PERIMETER mm.	585.116
DESCRIPTION	D TRANSON FIN BRACKET SECTION	WEIGHT kg/m	7.151
		DRAWING No.	SECTION No.
		P-20835	-
		S6785	S6785

NAME	DATE
J.P.KAUSHIK	27-02-2020

CHECKED	
APPROVED	B.NATARAJA 14-03-2020