

P-JAL-B-993

-

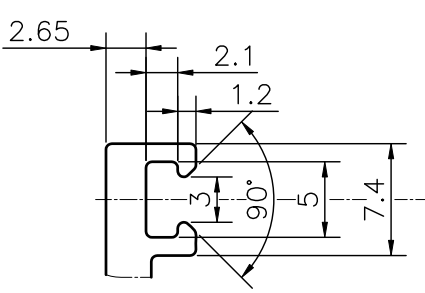

DETAIL A
SCALE 2:1

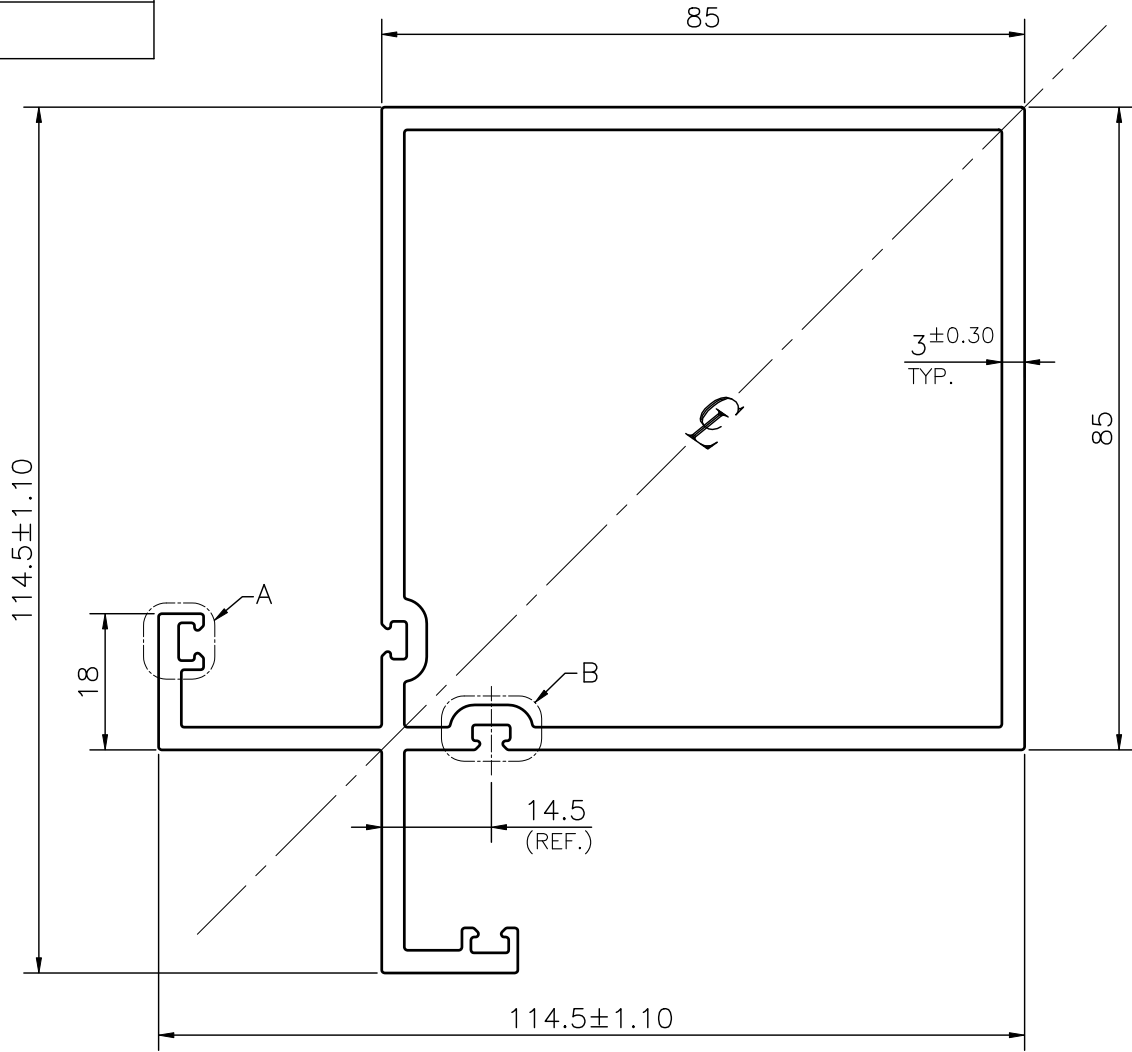
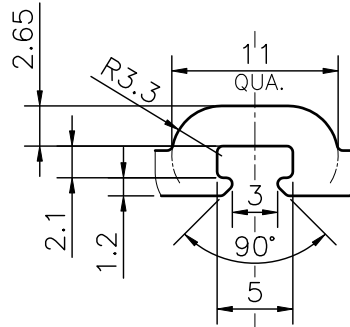

DETAIL B
SCALE 2:1

1. STRAIGHTNESS= 1.7mm/M
2. TWIST= 1.7mm/M
3. ANGULARITY= ±2°
4. FLATNESS= 0.007xWIDTH

Q03147

CONTROLLED COPY



SYMBOL OF QUALITY
AN ISO 9001 COMPANY

JINDAL ALUMINIUM LTD.
BHIWADI-301019 (INDIA)

	NAME	DATE
DRAWN	ASHUTOSH	07-03-2025
CHECKED	PARVESH	22-03-2025
APPROVED	J.N.RAI	22-03-2025

1. ALL DIMENSIONS ARE IN mm.
2. ROUND OFF ALL SHARP CORNERS WITH 0.40 mm.
3. TOLERANCES WILL BE AS PER BS:EN-755-9 , UNLESS OTHERWISE SPECIFIED

SCALE	1:1
AREA mm ²	1292.521
PERIMETER mm.	561.741
WEIGHT kg/m	3.490

PARTY'S NAME	AESTHETIC VISION FACADE SYSTEMS PVT. LTD., NOIDA	
PARTY'S DRAWING No.	AS PER DRAWING-ALUM. INWARD 90 DEGREE CORNER	
ALLOY & TEMPER	6063 T6	PRODUCT CODE:-055
		HSN CODE:- 76042100
DESCRIPTION	CURTAIN WALL SECTION	

DRAWING No.	SECTION No.
P-JAL-B-993	7000003922
X103676	X103676