

P-8027

X1058

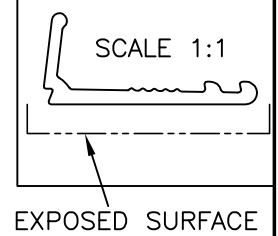
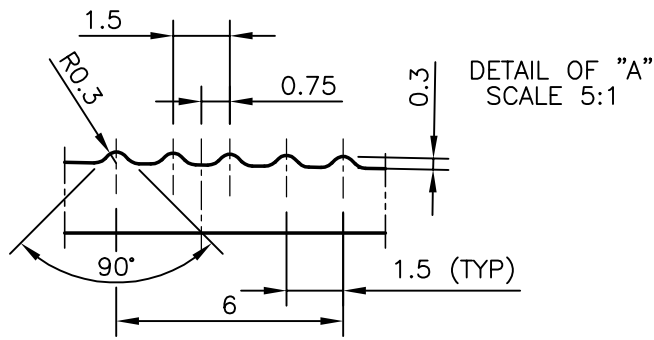

ISSUE: -2

- ② ANGLE CHANGED FROM 10° TO 7°
- OTHER TWO DIMENSIONS ALSO CHANGED FROM 22.4 TO 22.87 & 17.7 TO 18.17

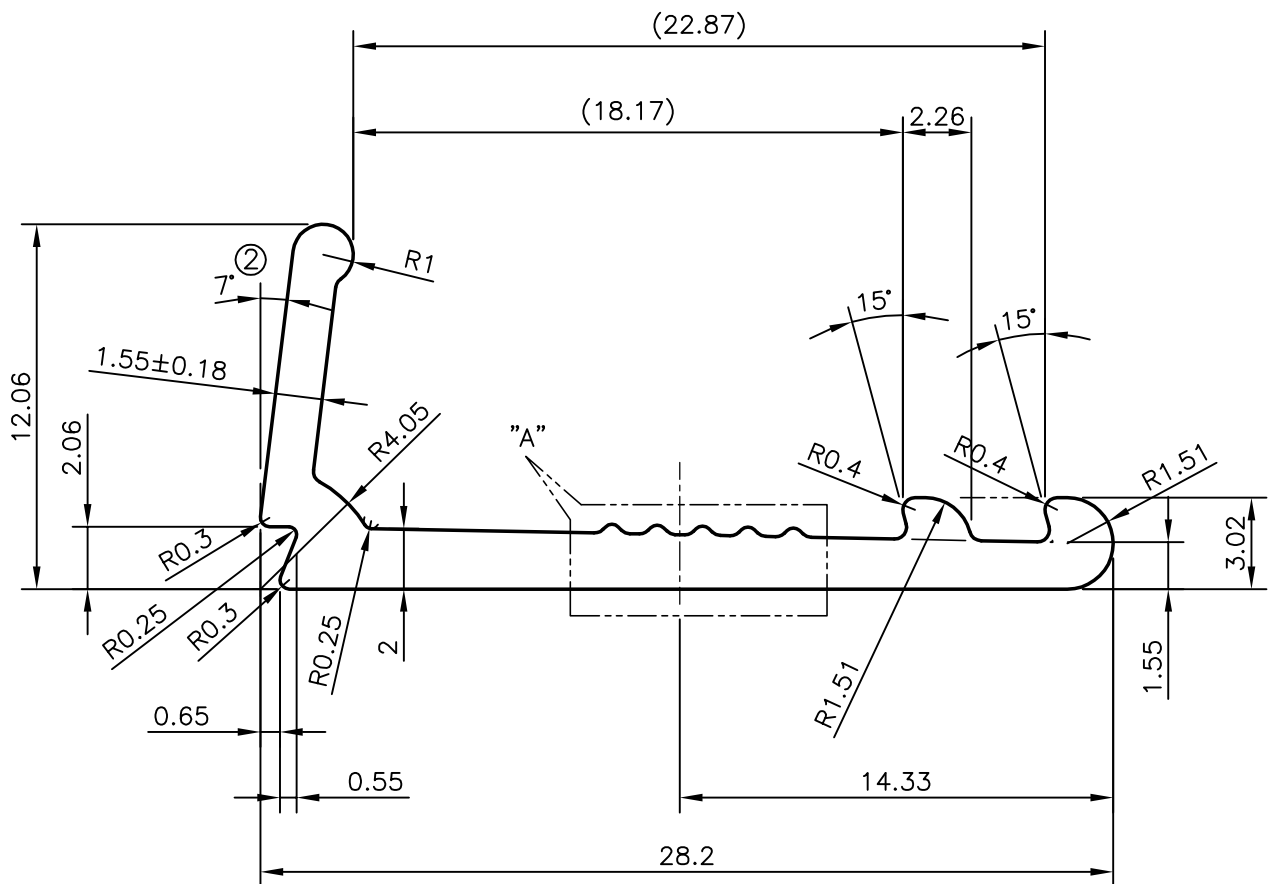

JINDAL ALUMINIUM LTD.
BANGALORE-560073 (INDIA)

	NAME	DATE
DRAWN	J.P.KAUSHIK	24-04-2010
CHECKED		
APPROVED	S.S.GARG	30-04-2010
SCALE		4:1
AREA mm ²		72.206
PERIMETER mm.		83.231
WEIGHT kg/m		0.195
DRAWING No.	SECTION No.	
P-8027	-	
X1058	X1058(ISSUE-2)	

1. ALL DIMENSIONS ARE IN mm.
2. ROUND OFF ALL SHARP CORNERS WITH 0.40 mm.
3. TOLERANCES WILL BE AS PER BS:EN-755 UNLESS OTHERWISE SPECIFIED

PARTY'S NAME	PROSOURCE INDUSTRIAL SOLUTIONS, CANADA
PARTY'S DRAWING No.	WS-8602
ALLOY & TEMPER	6063 T54
DESCRIPTION	MISC. SECTION