

P-5626-2
 28904
 X1149

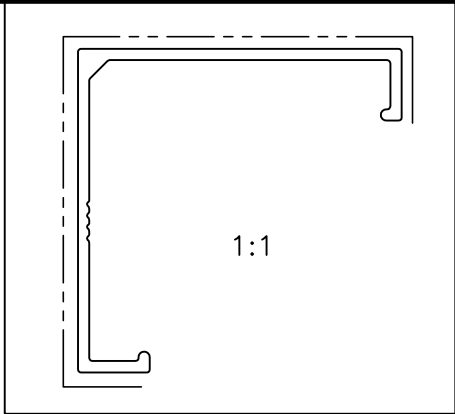

----- DENOTES VISIBLE SURFACE
 F = FULL RADIUS (2)
 ID = VEE GROOVE 4NO. 0.30x90°xR0.3
 GENERAL WALL THICKNESS = 1.5 mm

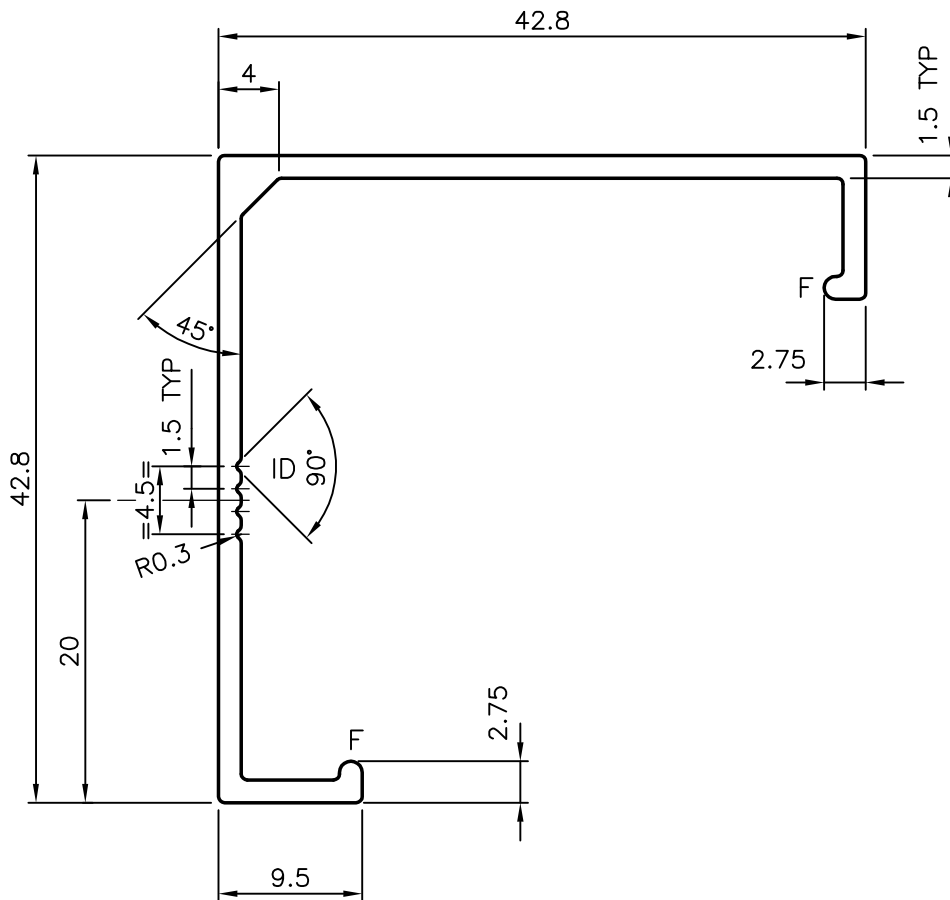

JINDAL ALUMINIUM LTD.
 BANGALORE-560073 (INDIA)

	NAME	DATE
DRAWN	MALINGAPPA	17-07-2005
CHECKED		
APPROVED		
SCALE		2:1
AREA mm ²		155.844
PERIMETER mm.		204.622
WEIGHT kg/m		0.421
DRAWING No.	SECTION No.	
P-5626-2	-	
28904	28904	
X1149	X1149	

1. ALL DIMENSIONS ARE IN mm.
2. ROUND OFF ALL SHARP CORNERS WITH 0.40 mm.
3. TOLERANCES WILL BE AS PER BS:1474-1987 UNLESS OTHERWISE SPECIFIED

PARTY'S NAME	KOMFORT OFFICE ENVIRONMENTS PLC - U.K.
PARTY'S DRAWING No.	D4/805/0000 (ISSUE-3)
ALLOY & TEMPER	6063 TF
DESCRIPTION	EXTERNAL 90° COVER TRIM