

P-9126

X1161

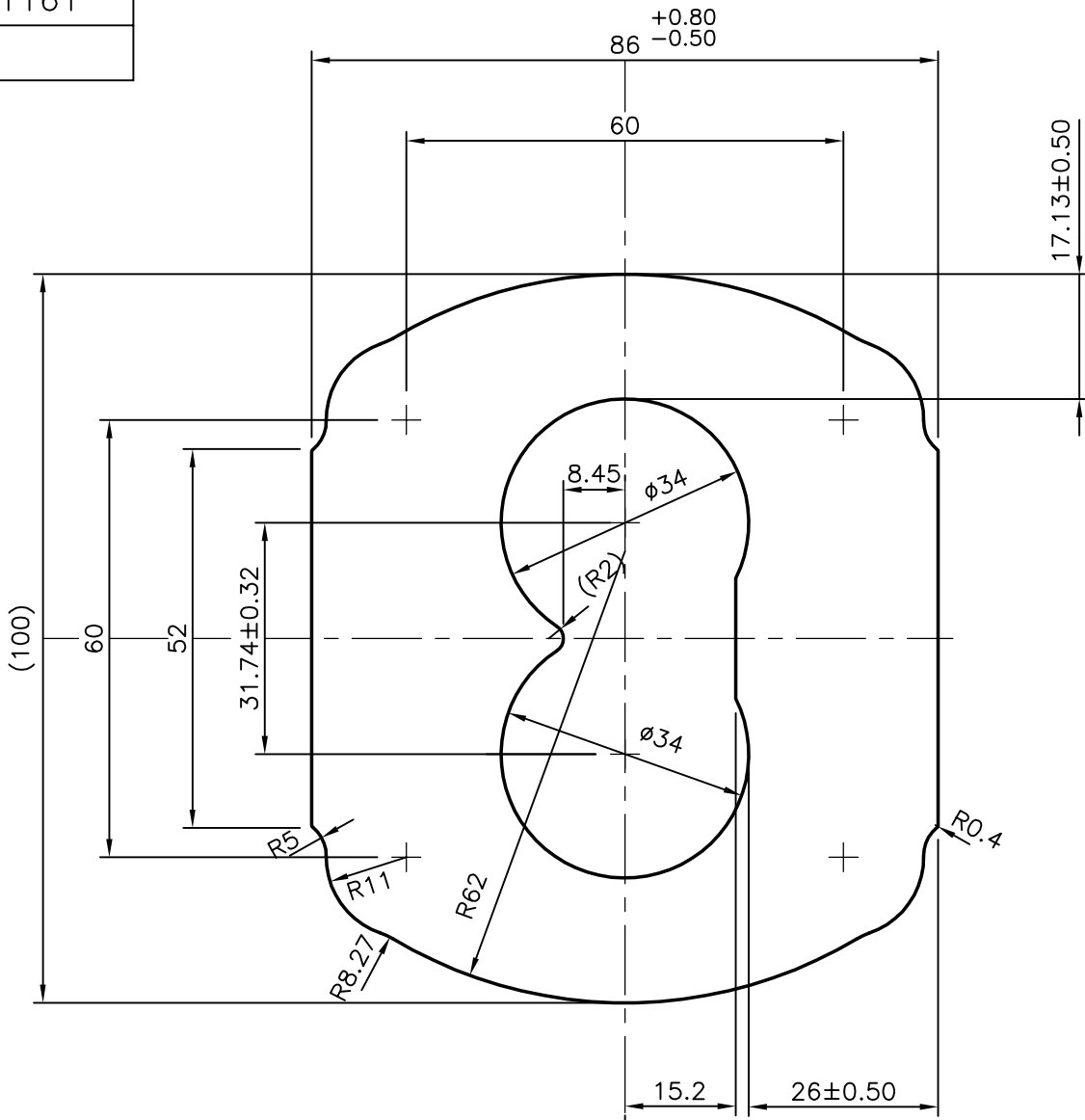

BEND:- 1.5 mm/M  
0.6mm/300 mm

TWIST:- 2 mm/M  
3.5mm/3000 mm



SYMBOL OF QUALITY  
AN ISO 9001 COMPANY

**JINDAL ALUMINIUM LTD.**  
BANGALORE-560073 (INDIA)

	NAME	DATE
DRAWN	J.P.KAUSHIK	19-03-2009
CHECKED		
APPROVED		

1. ALL DIMENSIONS ARE IN mm.
2. ROUND OFF ALL SHARP CORNERS WITH 0.40 mm.
3. TOLERANCES WILL BE AS PER BS:EN-755 UNLESS OTHERWISE SPECIFIED

SCALE	1:1
AREA mm <sup>2</sup>	5764.787
PERIMETER mm.	318.394
WEIGHT kg/m	15.565

PARTY'S NAME HEMA ENDUSTRI A.S.- TURKEY

PARTY'S DRAWING No. 1PN-100-004

ALLOY & TEMPER 6082 T6

DESCRIPTION PUMP BODY

DRAWING No.	SECTION No.
P-9126	-
X1161	X1161