

P-9345

X1194

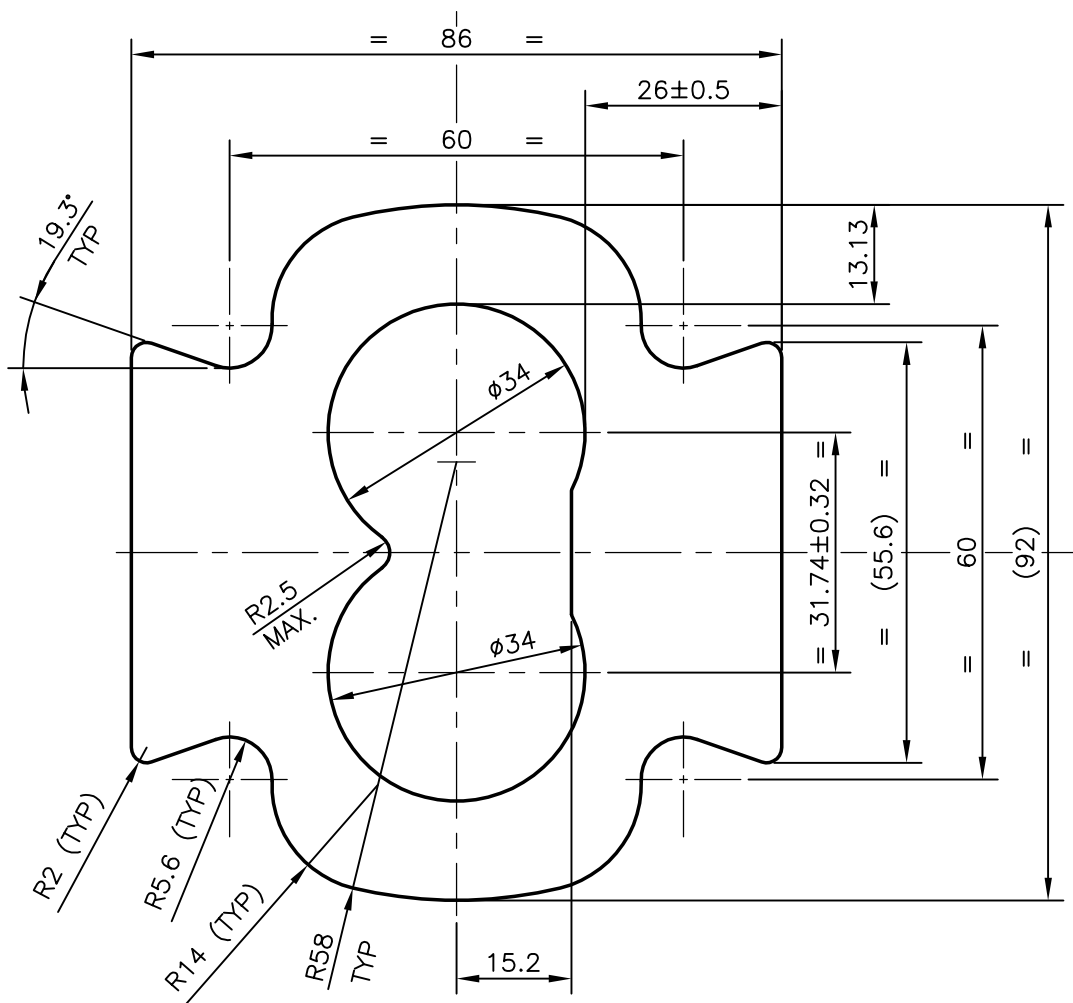

BEND:- 1.5 mm/M
0.6mm/300 mm

TWIST:- 2 mm/M
3.5mm/3000 mm



SYMBOL OF QUALITY
AN ISO 9001 COMPANY

JINDAL ALUMINIUM LTD.
BANGALORE-560073 (INDIA)

	NAME	DATE
DRAWN	PRASANNA.H	27-06-2009
CHECKED		
APPROVED		

1. ALL DIMENSIONS ARE IN mm.
2. ROUND OFF ALL SHARP CORNERS WITH 0.40 mm.
3. TOLERANCES WILL BE AS PER BS:EN-755 UNLESS OTHERWISE SPECIFIED

SCALE	1:1
AREA mm ²	4319.923
PERIMETER mm.	330.186
WEIGHT kg/m	11.664

PARTY'S NAME HEMA ENDUSTRI A.S.- TURKEY

PARTY'S DRAWING No. IPA-100-004 (PI)

ALLOY & TEMPER 6351 T6 (HE30 WP)

DESCRIPTION PUMP BODY SECTION

DRAWING No.	SECTION No.
P-9345	-
X1194	X1194