

P-9908

X1309

EXPOSED SURFACE

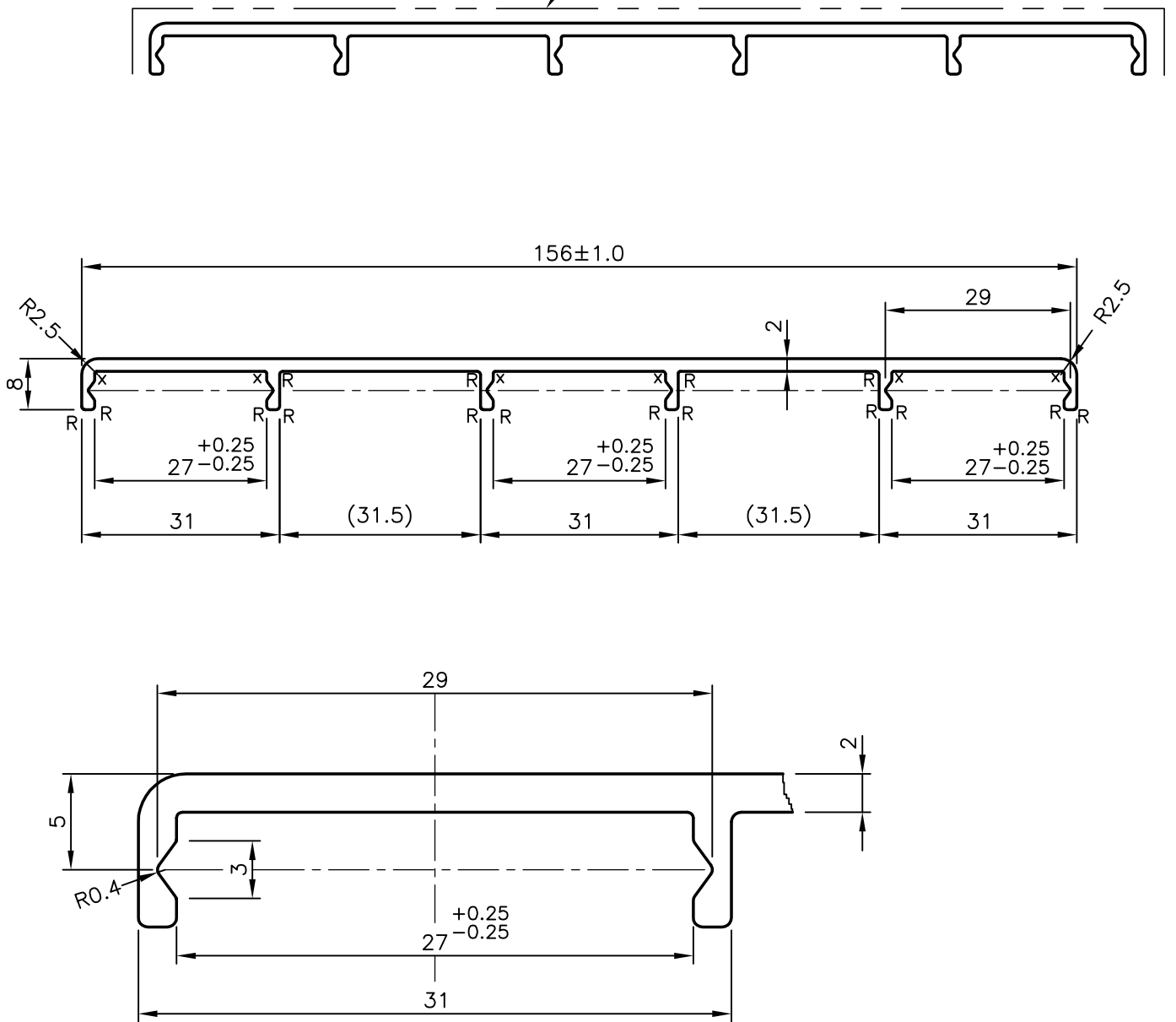

STRAIGHTNESS = 1.2 mm/1000 mm

PERMANENT EXCLUSIVE

x = 0.3 RADII (6 PLACES)

R = 0.5 RADII (16 PLACES)



SYMBOL OF QUALITY
AN ISO 9001 COMPANY

JINDAL ALUMINIUM LTD.
BANGALORE-560073 (INDIA)

	NAME	DATE
DRAWN	J.P.KAUSHIK	20-03-2010
CHECKED		
APPROVED	S.S.GARG	03-06-2010
SCALE		1:1
AREA mm ²		371.311
PERIMETER mm.		385.096
WEIGHT kg/m		1.003
DRAWING No.	SECTION No.	
P-9908	-	
X1309	X1309	

1. ALL DIMENSIONS ARE IN mm.
2. ROUND OFF ALL SHARP CORNERS WITH 0.40 mm.
3. TOLERANCES WILL BE AS PER DIN 12020 UNLESS OTHERWISE SPECIFIED

PARTY'S NAME	COSIGN NV, BELGIUM
PARTY'S DRAWING No.	D2007_0469
ALLOY & TEMPER	6060 T6
DESCRIPTION	MISC. SECTION