

P-9899

X1323

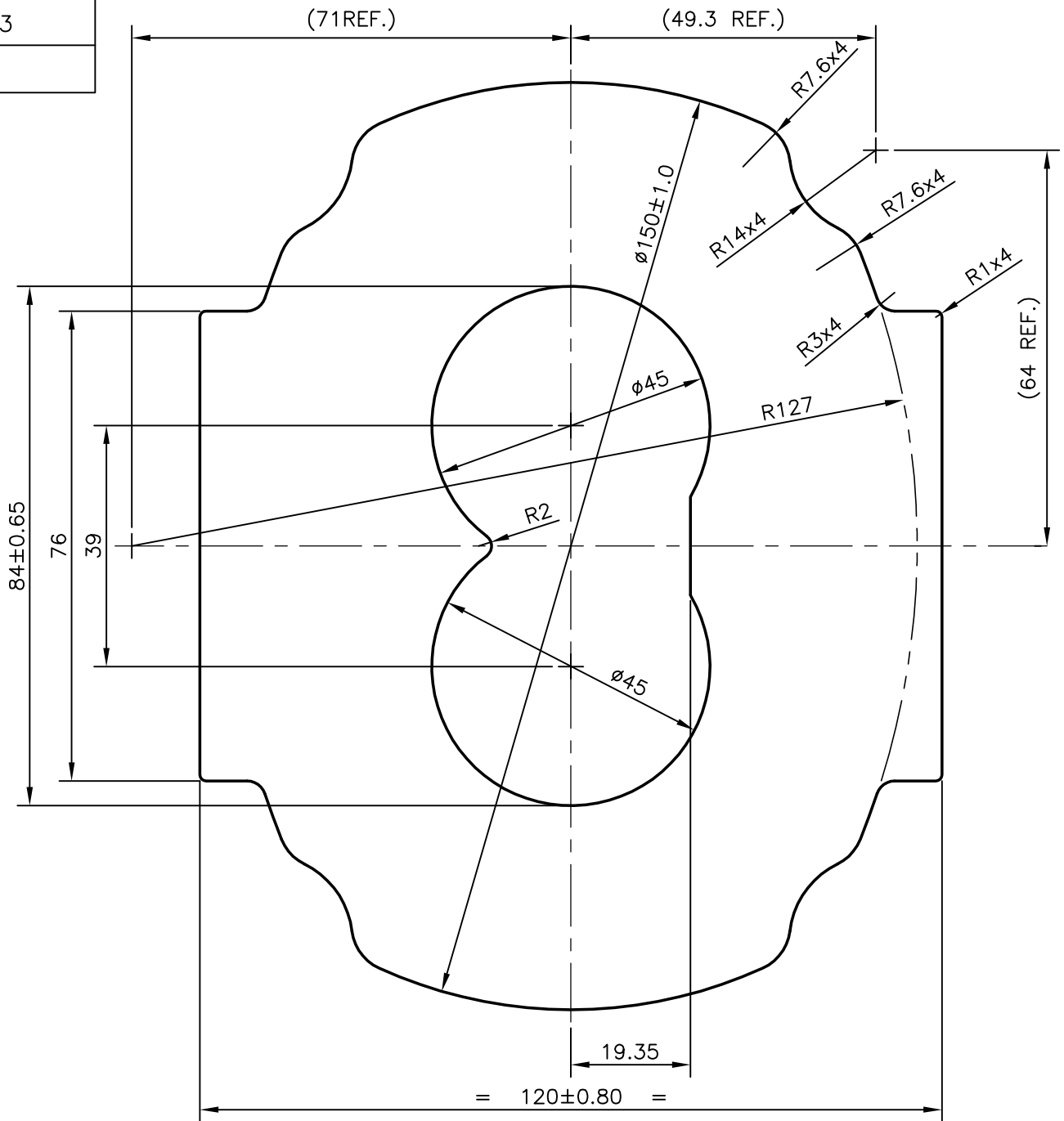

BEND:- 1.5 mm/M
 0.6mm/300 mm
 TWIST:- 2 mm/M
 3.5mm/3000 mm



SYMBOL OF QUALITY
 AN ISO 9001 COMPANY

JINDAL ALUMINIUM LTD.
 BANGALORE-560073 (INDIA)

	NAME	DATE
DRAWN	J.P.KAUSHIK	17-03-2010
CHECKED		
APPROVED	S.S.GARG	26-06-2010
SCALE		1:1
AREA mm ²		11557.494
PERIMETER mm.		464.01
WEIGHT kg/m		31.205
DRAWING No.	SECTION No.	
P-9899	-	
X1323	X1323	

1. ALL DIMENSIONS ARE IN mm.
2. ROUND OFF ALL SHARP CORNERS WITH 0.40 mm.
3. TOLERANCES WILL BE AS PER BS:EN-755 UNLESS OTHERWISE SPECIFIED

PARTY'S NAME	HEMA ENDUSTRI A.S.- TURKEY
PARTY'S DRAWING No.	2P1-3000-307
ALLOY & TEMPER	HE30 TF
DESCRIPTION	PUMP BODY SECTION