

P-10557

X1428

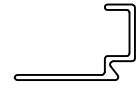

1:1

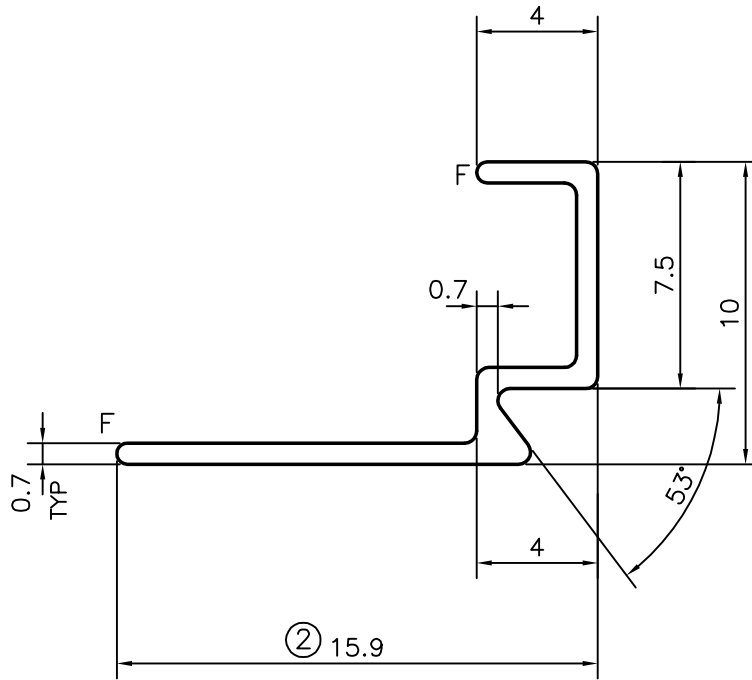
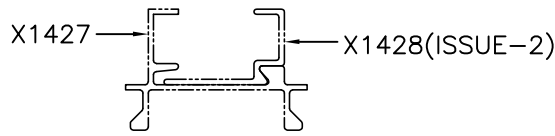

ISSUE-2:-

DIMENSION CHANGE FROM 16.5 mm TO 15.9 mm
 WEIGHT ALSO CHANGED FROM 0.058 kg/M TO 0.057 kg/M

F = FULL RADIUS (2 PLACES)

PERMANENT EXCLUSIVE



SYMBOL OF QUALITY
 AN ISO 9001 COMPANY

JINDAL ALUMINIUM LTD.
 BANGALORE-560073 (INDIA)

	NAME	DATE
DRAWN	J.P.KAUSHIK	22-12-2010
CHECKED		
APPROVED	S.S.GARG	31-12-2010
SCALE		4:1
AREA mm ²		21.194
PERIMETER mm.		57.847
WEIGHT kg/m		0.057
DRAWING No.	SECTION No.	
P-10557	-	
X1428	X1428(ISSUE-2)	

1. ALL DIMENSIONS ARE IN mm.
2. ROUND OFF ALL SHARP CORNERS WITH 0.40 mm.
3. TOLERANCES WILL BE AS PER IS:3965-1981 UNLESS OTHERWISE SPECIFIED

PARTY'S NAME	ASHWANI & SONS, GHAZIABAD
PARTY'S DRAWING No.	AS PER DRAWING
ALLOY & TEMPER	HE9 WP
DESCRIPTION	WINDOW SECTION