

P-11044-2

X1526

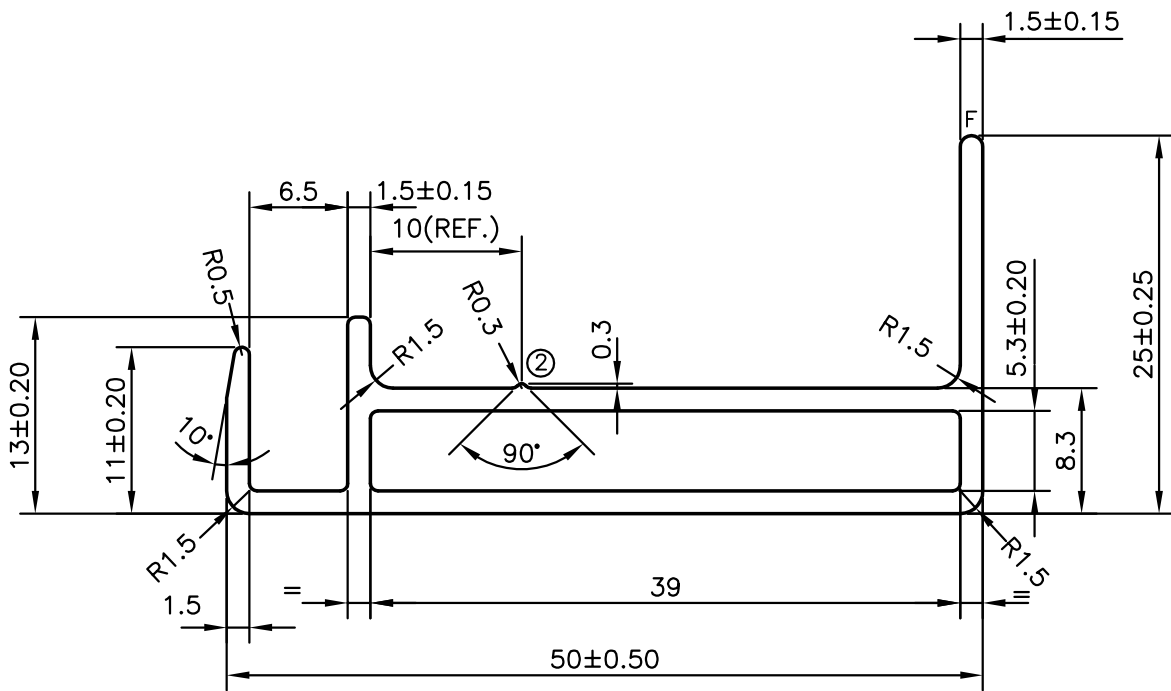
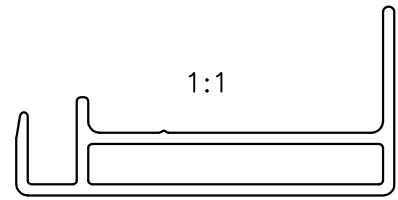

ISSUE-2 V GROOVE ADDED

F = FULL RADIUS  
UNSPECIFIED RADIUS 0.5 mm



SYMBOL OF QUALITY  
AN ISO 9001 COMPANY

**JINDAL ALUMINIUM LTD.**  
BANGALORE-560073 (INDIA)

	NAME	DATE
DRAWN	J.P.KAUSHIK	26-08-2011
CHECKED		
APPROVED	S.S.GARG	24-11-2011
SCALE		2:1
AREA mm <sup>2</sup>		199.35
PERIMETER mm.		173.617
WEIGHT kg/m		0.538
DRAWING No.	SECTION No.	
P-11044-2	-	
X1526	X1526(ISSUE-2)	

1. ALL DIMENSIONS ARE IN mm.
2. ROUND OFF ALL SHARP CORNERS WITH 0.50 mm.
3. TOLERANCES WILL BE AS PER, IS:6477-1983 UNLESS OTHERWISE SPECIFIED

PARTY'S NAME	EMMVEE PHOTOVOLTAIC POWER PVT. LTD., BANGALORE
PARTY'S DRAWING No.	MV-PV-E-004A
ALLOY & TEMPER	HE9 WP
DESCRIPTION	SOLAR POWER SECTION