

P-14066

X1872

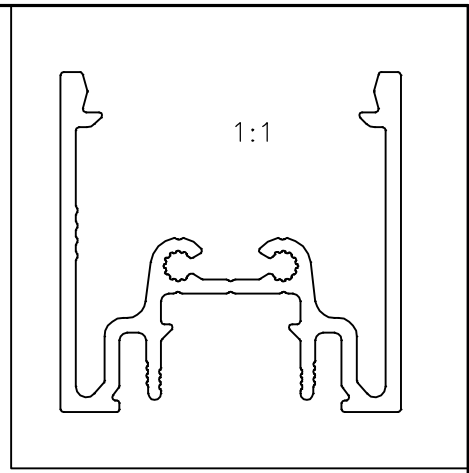

SCALE:-3:1  
**DETAIL-A**

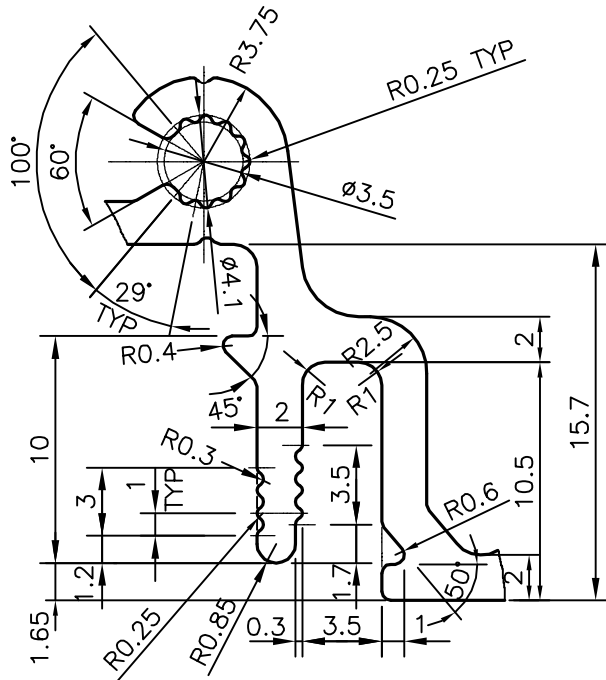
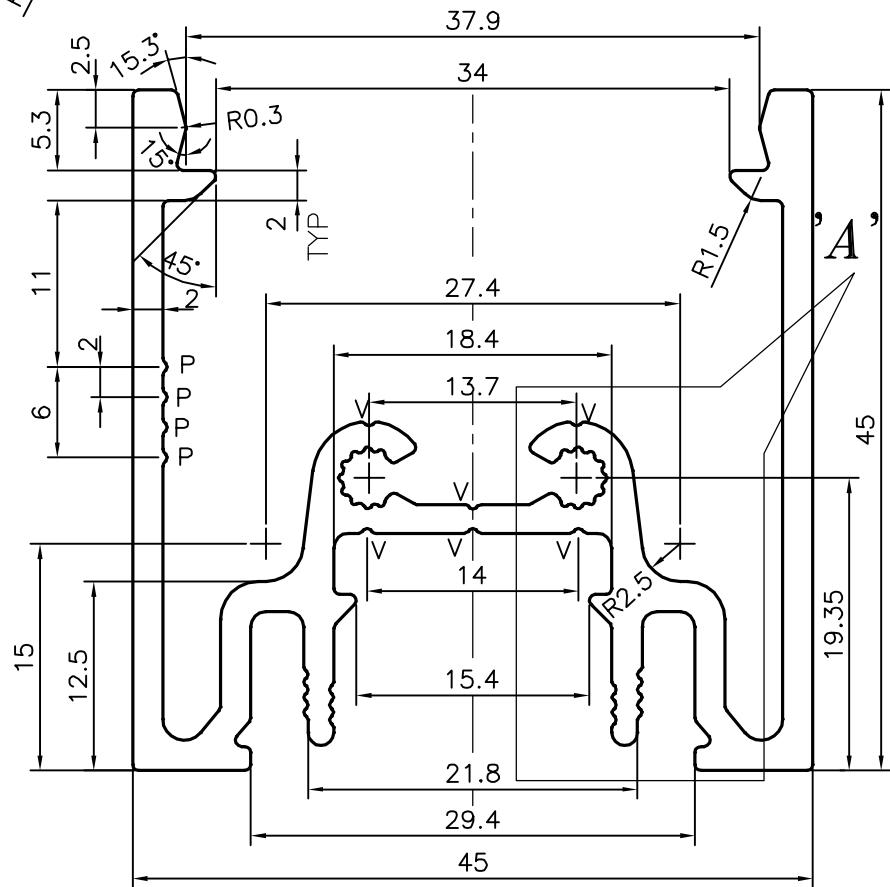

P = PIP 0.3x90°xR0.3 (4 PLACES)

V = VEE GROOVE 0.3x90°xR0.3 (6 PLACES)



SYMBOL OF QUALITY  
AN ISO 9001 COMPANY

**JINDAL ALUMINIUM LTD.**  
BANGALORE-560073 (INDIA)

	NAME	DATE
DRAWN	J.P.KAUSHIK	28-10-2014
CHECKED		
APPROVED	S.S.GARG	07-05-2015

- ALL DIMENSIONS ARE IN mm.
- ROUND OFF ALL SHARP CORNERS WITH 0.40 mm.
- TOLERANCES WILL BE AS PER BS:EN-755-9 UNLESS OTHERWISE SPECIFIED

SCALE	2:1
AREA mm <sup>2</sup>	421.909
PERIMETER mm.	410.538
WEIGHT kg/m	1.139
DRAWING No.	SECTION No.
P-14066	-
X1872	X1872

PARTY'S NAME	PD ALUMINIUM LTD., UK
PARTY'S DRAWING No.	AS PER SAMPLE (CS 117) NEW
ALLOY & TEMPER	6063 T6
DESCRIPTION	MISC. SECTION