

P-14738

X1900

EXPOSED SURFACE

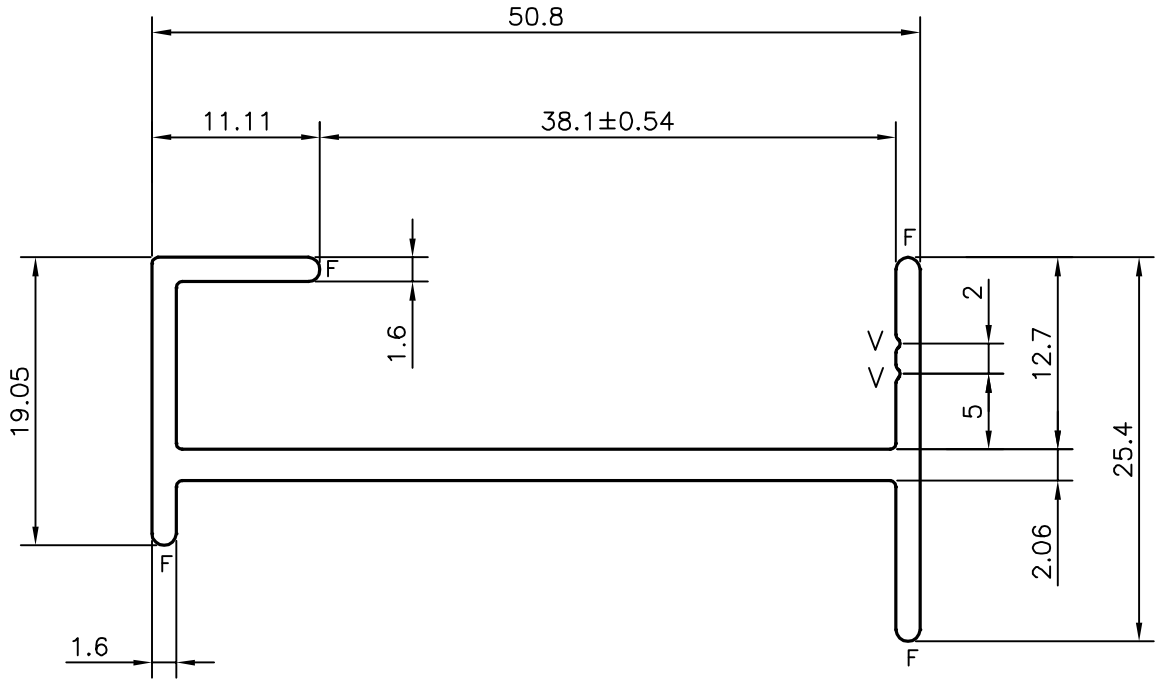
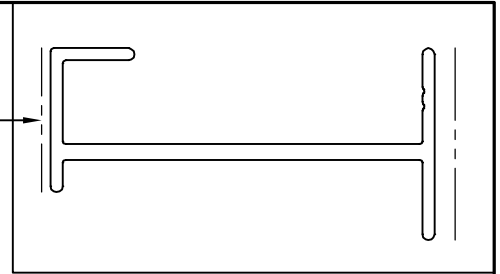

V = V GROOVE 0.3x90° (2 PLACES)  
 F = FULL RADIUS (4 PLACES)



SYMBOL OF QUALITY  
 AN ISO 9001 COMPANY

**JINDAL ALUMINIUM LTD.**  
 BANGALORE-560073 (INDIA)

	NAME	DATE
DRAWN	J.P.KAUSHIK	09-06-2015
CHECKED		
APPROVED	B.NATARAJA	15-07-2015

1. ALL DIMENSIONS ARE IN mm.
2. ROUND OFF ALL SHARP CORNERS WITH 0.40 mm.
3. TOLERANCES WILL BE AS PER BS:EN-755-9 UNLESS OTHERWISE SPECIFIED

SCALE	2:1
AREA mm <sup>2</sup>	182.869
PERIMETER mm.	202.008
WEIGHT kg/m	0.494

PARTY'S NAME	BADER AL MULLA & BROS. CO. W.L.L, KUWATI
PARTY'S DRAWING No.	960792
ALLOY & TEMPER	6063 T6
DESCRIPTION	VRAIE GRANDEUR SECTION

DRAWING No.	SECTION No.
P-14738	
X1900	X1900