

P-15358

X1948

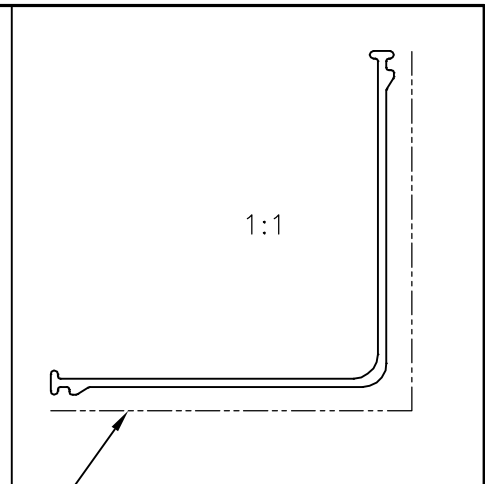

1:1

EXPOSED SURFACE

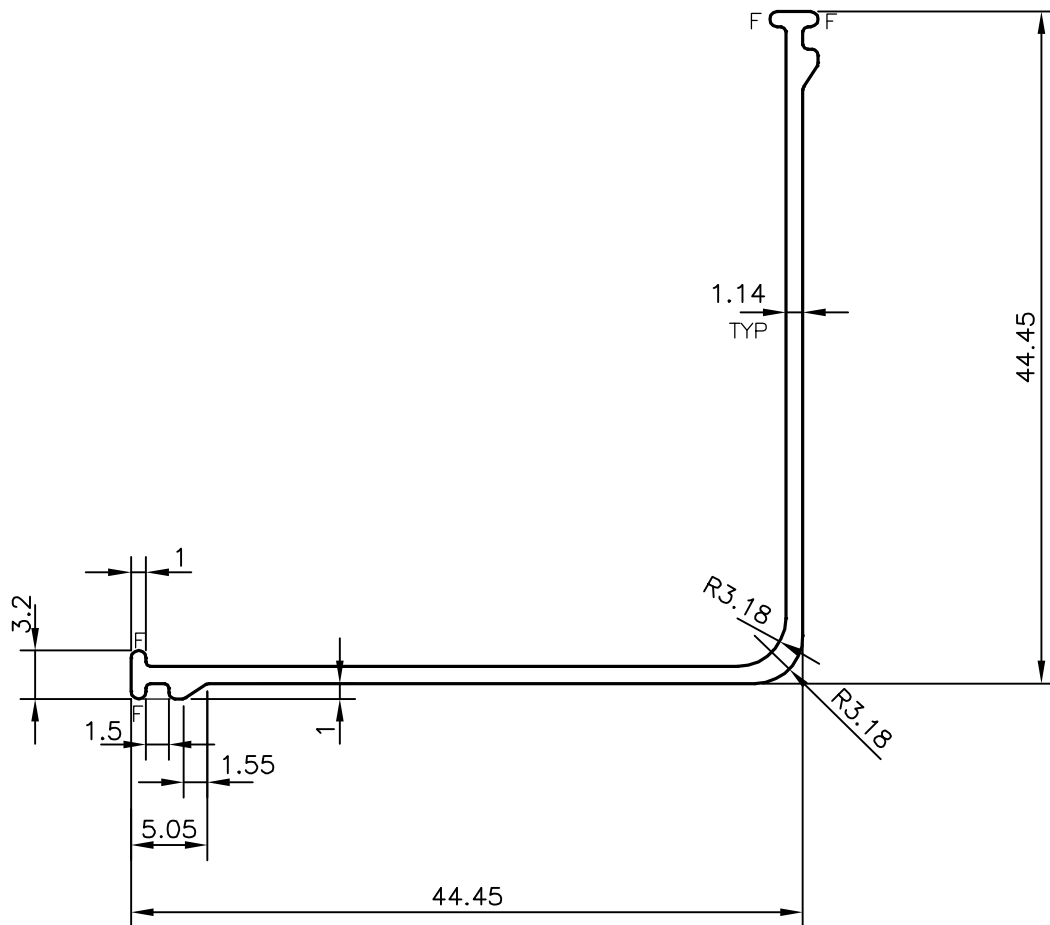

F= FULL RADIUS (4 PLACES)



SYMBOL OF QUALITY  
AN ISO 9001 COMPANY

**JINDAL ALUMINIUM LTD.**  
BANGALORE-560073 (INDIA)

	NAME	DATE
DRAWN	J.P.KAUSHIK	26-11-2015
CHECKED	S.S.GARG	10-12-2015
APPROVED	S.S.GARG	10-12-2015
SCALE		2:1
AREA mm <sup>2</sup>		107.334
PERIMETER mm.		183.041
WEIGHT kg/m		0.290
DRAWING No.	SECTION No.	
P-15358	-	
X1948	X1948	

1. ALL DIMENSIONS ARE IN mm.
2. ROUND OFF ALL SHARP CORNERS WITH 0.40 mm.
3. TOLERANCES WILL BE AS PER BS:EN-755-9 , UNLESS OTHERWISE SPECIFIED

PARTY'S NAME	UNIVERSAL FABRICATING-CANADA
PARTY'S DRAWING No.	AS PER AutoCAD DRAWING ES-12946
ALLOY & TEMPER	6063 T6
DESCRIPTION	DRIP GUTTER SECTION