

P-17931

X2311

EXPOSED SURFACE

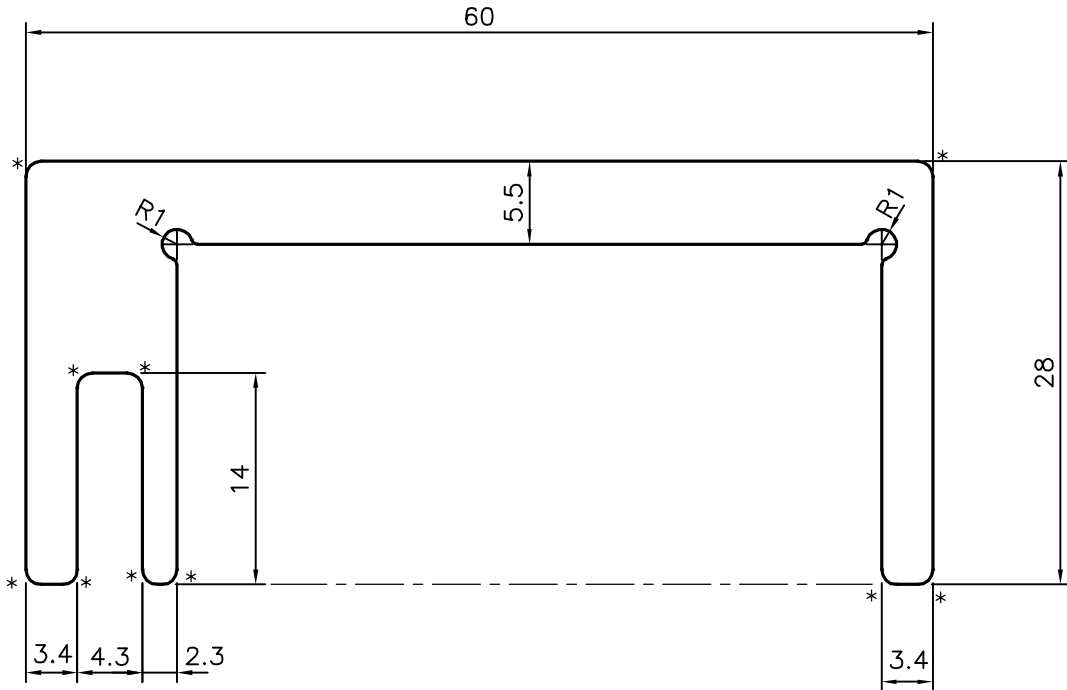
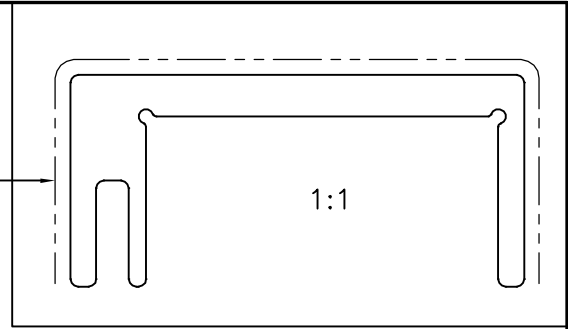

\* = 1.0 RADIUS(10 PLACES)



SYMBOL OF QUALITY  
AN ISO 9001 COMPANY

**JINDAL ALUMINIUM LTD.**  
BANGALORE-560073 (INDIA)

	NAME	DATE
DRAWN	J.P.KAUSHIK	26-02-2018
CHECKED		
APPROVED	B.NATARAJA	22-03-2018
SCALE		2:1
AREA mm <sup>2</sup>		565.216
PERIMETER mm.		249.657
WEIGHT kg/m		1.526
DRAWING No.	SECTION No.	
P-17931	-	
X2311	X2311	

1. ALL DIMENSIONS ARE IN mm.
2. ROUND OFF ALL SHARP CORNERS WITH 0.40 mm.
3. TOLERANCES WILL BE AS PER BS:EN-755-9 UNLESS OTHERWISE SPECIFIED

PARTY'S NAME	THYSSENKRUPP MATERIALS, BELGIUM NV
PARTY'S DRAWING No.	ZW_D021128
ALLOY & TEMPER	6060 T66
DESCRIPTION	MISC. SECTION