

P-20932-1

X2655

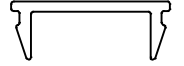

1:1

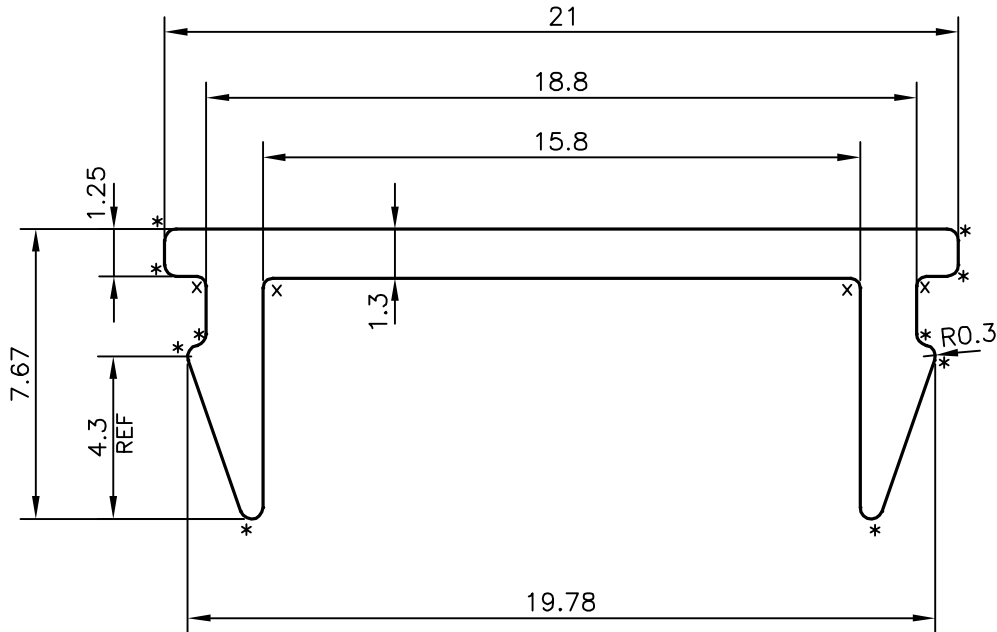

TOLERANCE CHART CD = CIRCUMSCRIBING CIRCLE

	CD ≤ 100	100 < CD ≤ 200	200 < CD ≤ 300	300 < CD ≤ 500
UPTO 10mm - ±0.25	±0.30	±0.35	±0.40	
10.0 - 25.0 - ±0.30	±0.40	±0.50	±0.60	
25.0 - 50.0 - ±0.50	±0.60	±0.80	±0.90	
50.0 - 100.0 - ±0.70	±0.90	±1.10	±1.30	
100 - 150 - -	±1.10	±1.30	±1.50	
150 - 200 - -	±1.3	±1.50	±1.80	
200 - 300 - -	-	±1.70	±2.10	
300 - 450 - -	-	-	±2.80	

x = 0.25 RADIUS(4 PLACES)
 * = 0.30 RADIUS(10 PLACES)



SYMBOL OF QUALITY
 AN ISO 9001 COMPANY

JINDAL ALUMINIUM LTD.
 BANGALORE-560073 (INDIA)

	NAME	DATE
DRAWN	J.P.KAUSHIK	09-05-2020
CHECKED		
APPROVED	B.NATARAJA	26-05-2020

- ALL DIMENSIONS ARE IN mm.
- ROUND OFF ALL SHARP CORNERS WITH 0.40 mm.
- TOLERANCES WILL BE AS PER BS:EN-755-9 , UNLESS OTHERWISE SPECIFIED

SCALE	5:1
AREA mm ²	44.449
PERIMETER mm.	67.774
WEIGHT kg/m	0.120
DRAWING No.	SECTION No.
P-20932-1	-
X2655	X2655

PARTY'S NAME	PERFECT GLAZE, UNITED KINGDOM
PARTY'S DRAWING No.	EC21
ALLOY & TEMPER	6063 T6
DESCRIPTION	GLAZING SECTION