

P-23019

X3020

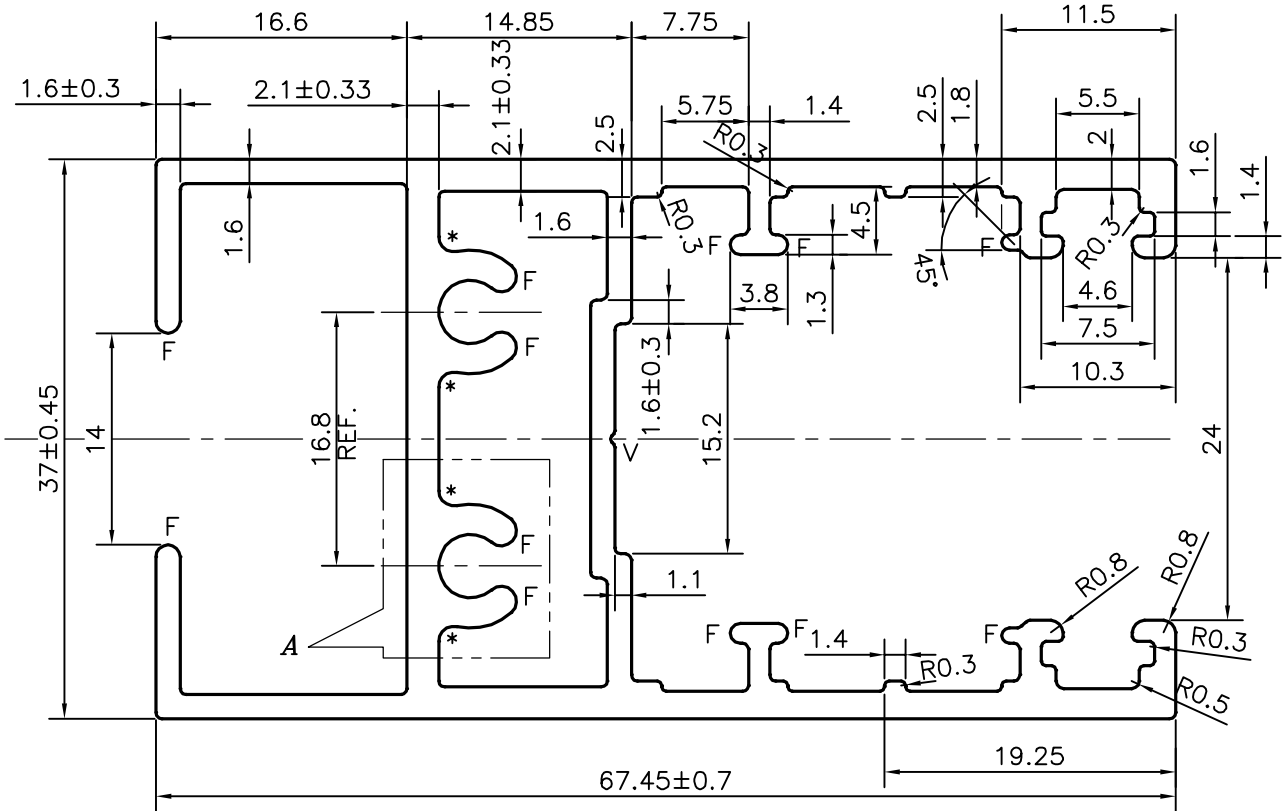
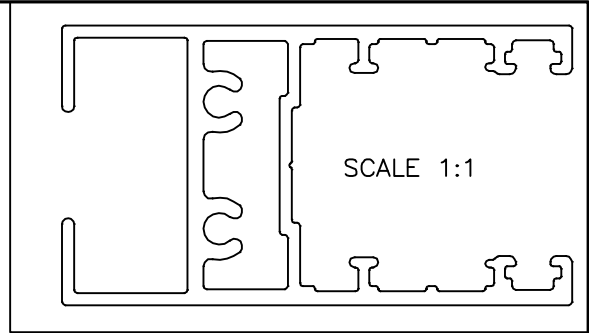
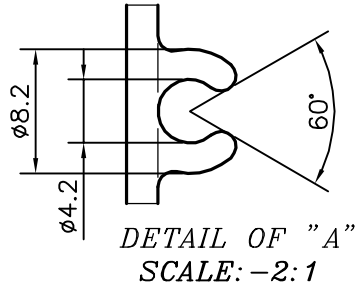

FINISH:- PVDF COATING

FINISH:- POWDER COATING

FINISH:- ANODIZING

V = "V" GROOVE 0.3X90°(1 PLACE)

* = 1mm RADIUS (4 PLACES)

F = FULL RADIUS (12 PLACES)

APPROXIMATE WEIGHT RANGE -1.135 - 1.659 kg/m

TOLERANCES ON OVERALL DIMENSIONS OF HOLLOW SECTIONS

UPTO 20.0mm - ±0.30	UPTO 80.0mm - ±0.70	UPTO 180.0mm - ±1.27	1. STRAIGHTNESS=1.7mm/M 2. TWIST=1.7mm/M 3. ANGULARITY= ±2° 4. FLATNESS =0.006xWIDTH
UPTO 30.0mm - ±0.38	UPTO 100.0mm - ±0.80	UPTO 200.0mm - ±1.40	
UPTO 40.0mm - ±0.45	UPTO 120.0mm - ±0.90	UPTO 225.0mm - ±1.52	
UPTO 50.0mm - ±0.52	UPTO 140.0mm - ±1.00		
UPTO 60.0mm - ±0.60	UPTO 160.0mm - ±1.14		



SYMBOL OF QUALITY
AN ISO 9001 COMPANY

JINDAL ALUMINIUM LTD.
BANGALORE-560073 (INDIA)

	NAME	DATE
DRAWN	PUNITH	29-09-2021
CHECKED		
APPROVED	B.NATARAJA	20-10-2021

- ALL DIMENSIONS ARE IN mm.
- ROUND OFF ALL SHARP CORNERS WITH 0.40 mm.
- TOLERANCES WILL BE AS PER IS:6477-1983 , UNLESS OTHERWISE SPECIFIED

SCALE	2:1
AREA mm ²	517.416
PERIMETER mm.	422.561
WEIGHT kg/m	1.397

PARTY'S NAME	RIDDHI SIDDHI INNOVATIONS (INDIA) PVT, LTD.	DRAWING No.	P-23019	SECTION No.	-
PARTY'S DRAWING No.	AS PER AUTOCAD DRAWING		X3020		X3020
ALLOY & TEMPER	6063 T6				
DESCRIPTION	SHUTTER SECTION				